

Available on orders entered on May 1, 2017.

New OIT used on Aquis™ and Advantus® Models:

The new OIT was improved to feature better functionality and standardization between the Aquis and Advantus Models. The new OIT will fit in the existing OIT cutout using oversized washers (see diagrams on Page 2).

NOTE: This is for the digital panel only. Manual panel is unchanged.



NOTE: The information in this technical bulletin was current at the time of printing. Waterous reserves the right to change this information.

CURRENT DESIGN

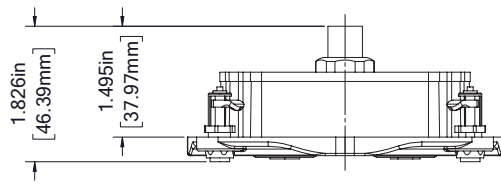

NEW DESIGN

