

Dimensional Drawings For CP-2 Series Fire Pumps

Basic Pump			Drive		Pump Model	See Page			
Series	Intake		Transmission Models	Input Rotation (1)		Basic Pump Dimensions	Pump and Transmission Dimension	Pump Discharge Positions	Transmission Mounting Positions
	Type	Size							
CP-2	NPT Or BSP (F)	3 in.	K Series Two Gear Increaser, (No Clutch)	CW Or CCW	CPK-2	2	3	5	6
			T Series Two Gear Increaser, Direct Engine Mount	CW Or CWW	CPT-2	2	4		

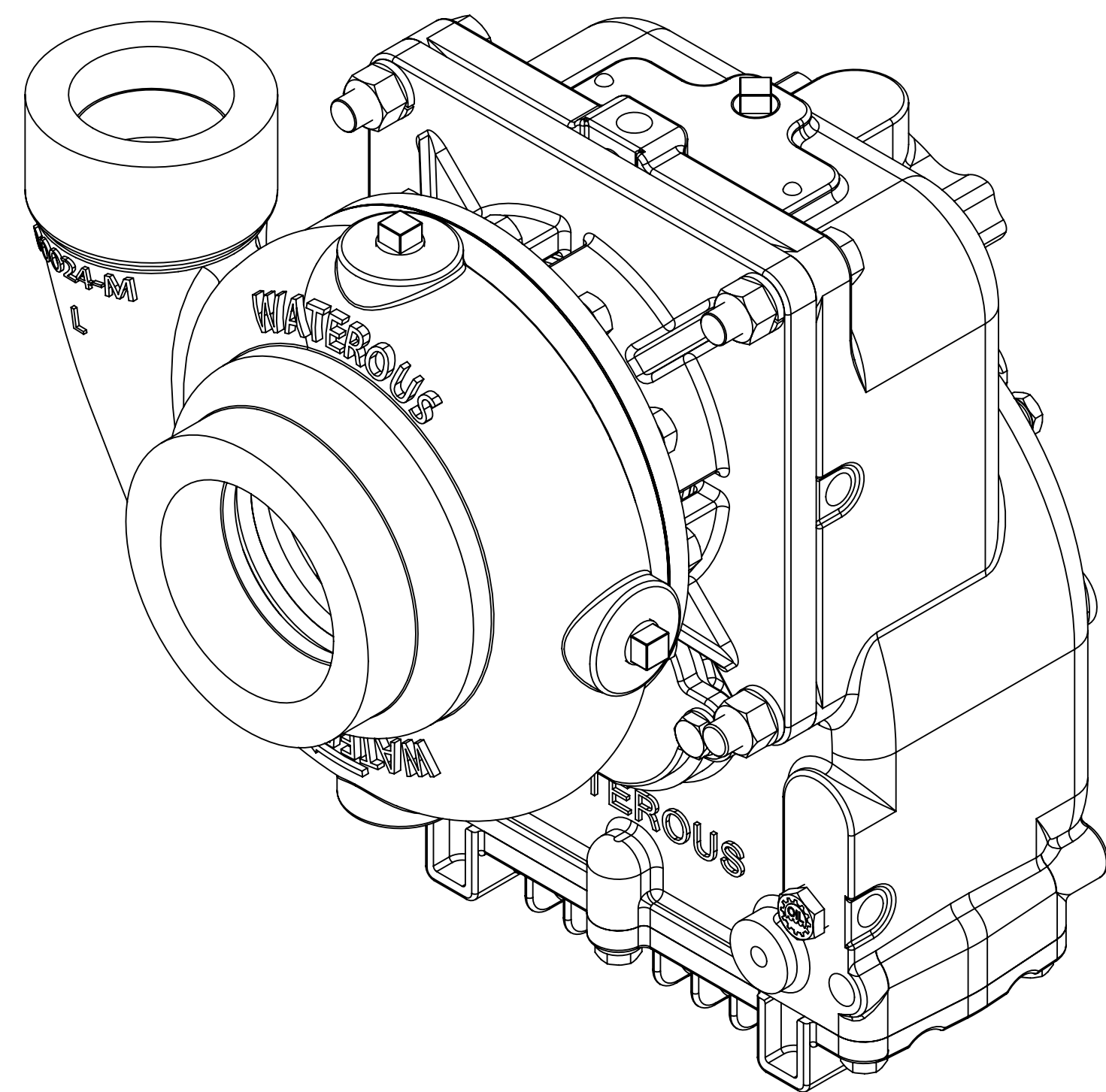

CP-2 K Series

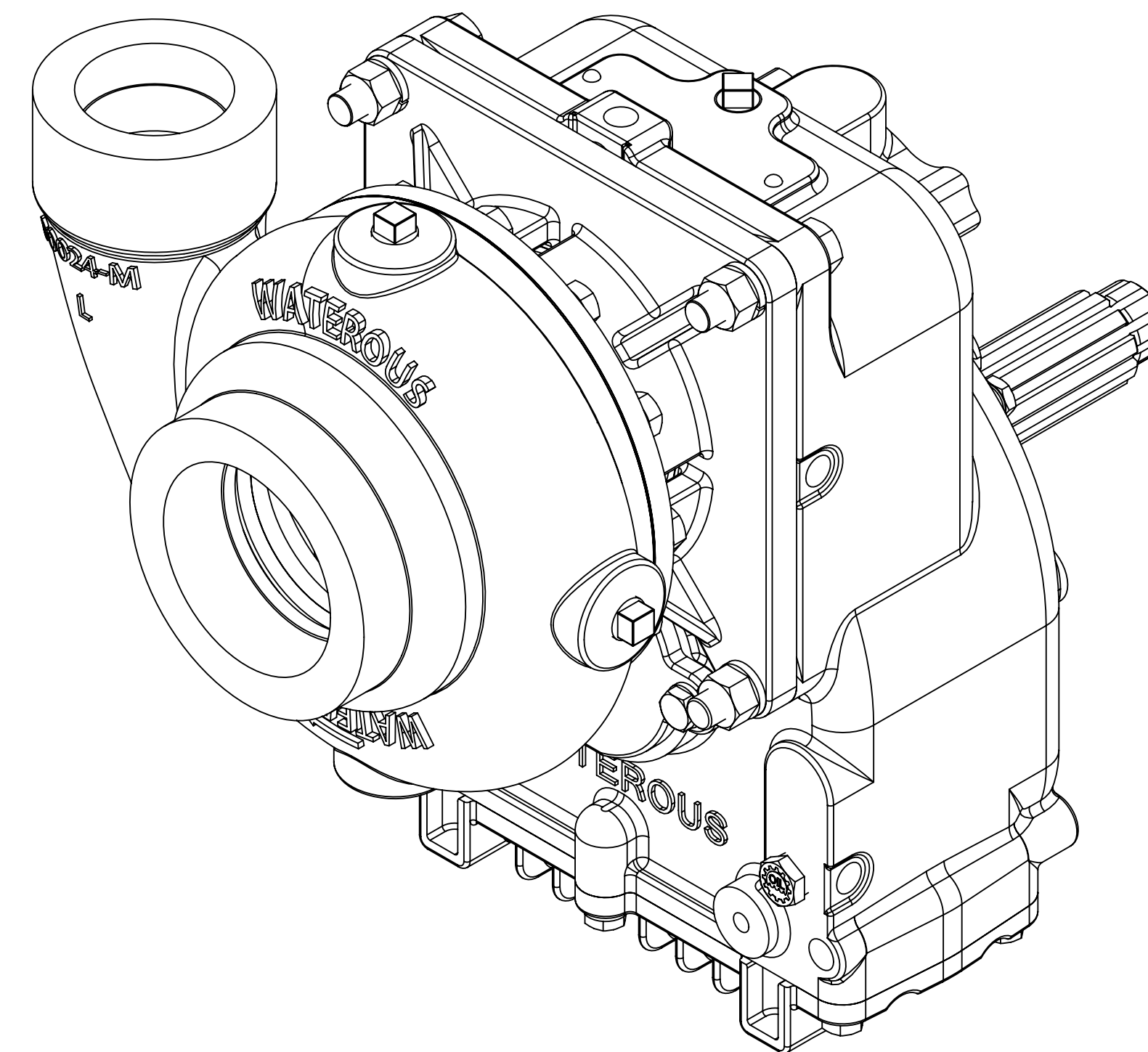

CP-2 T Series

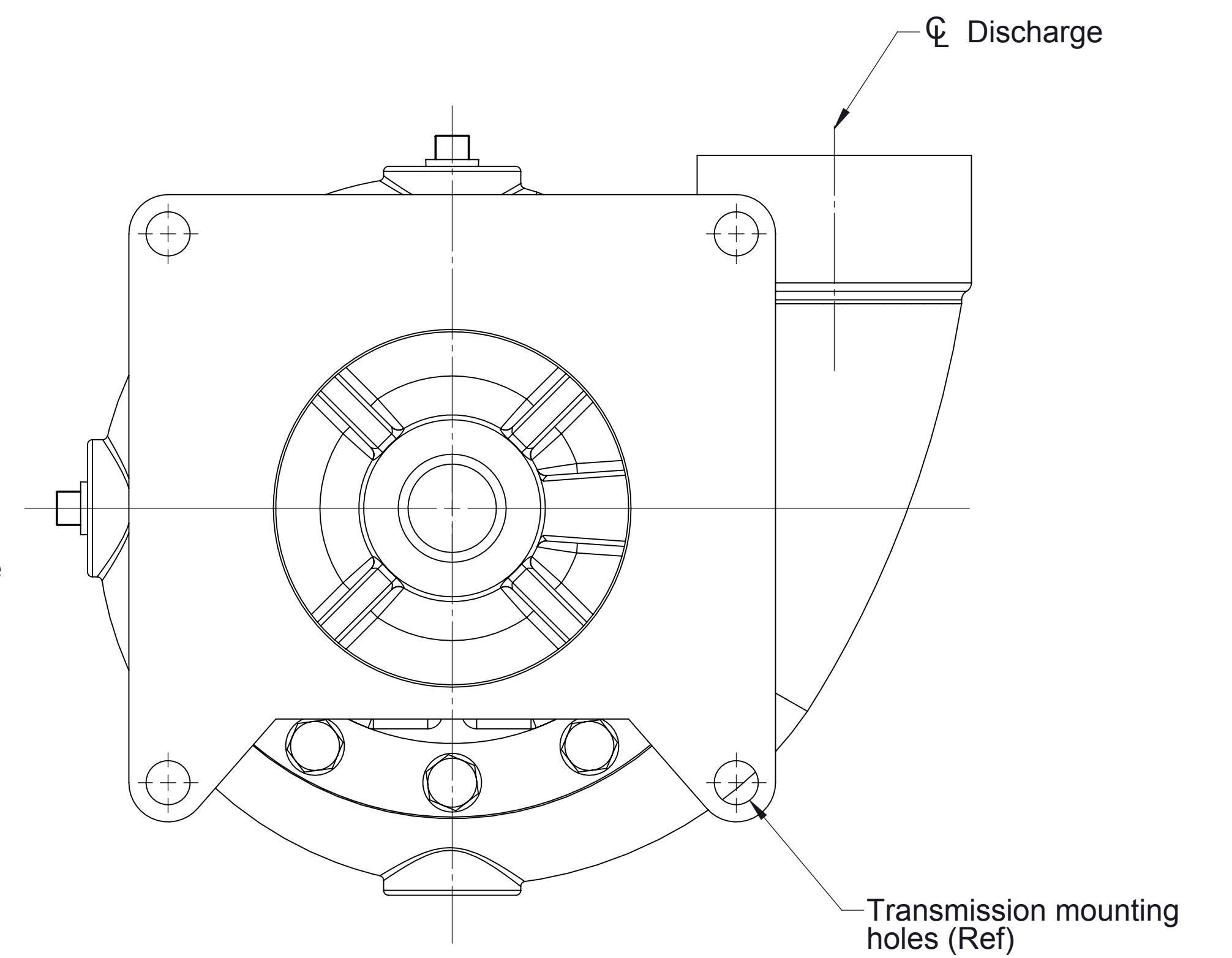
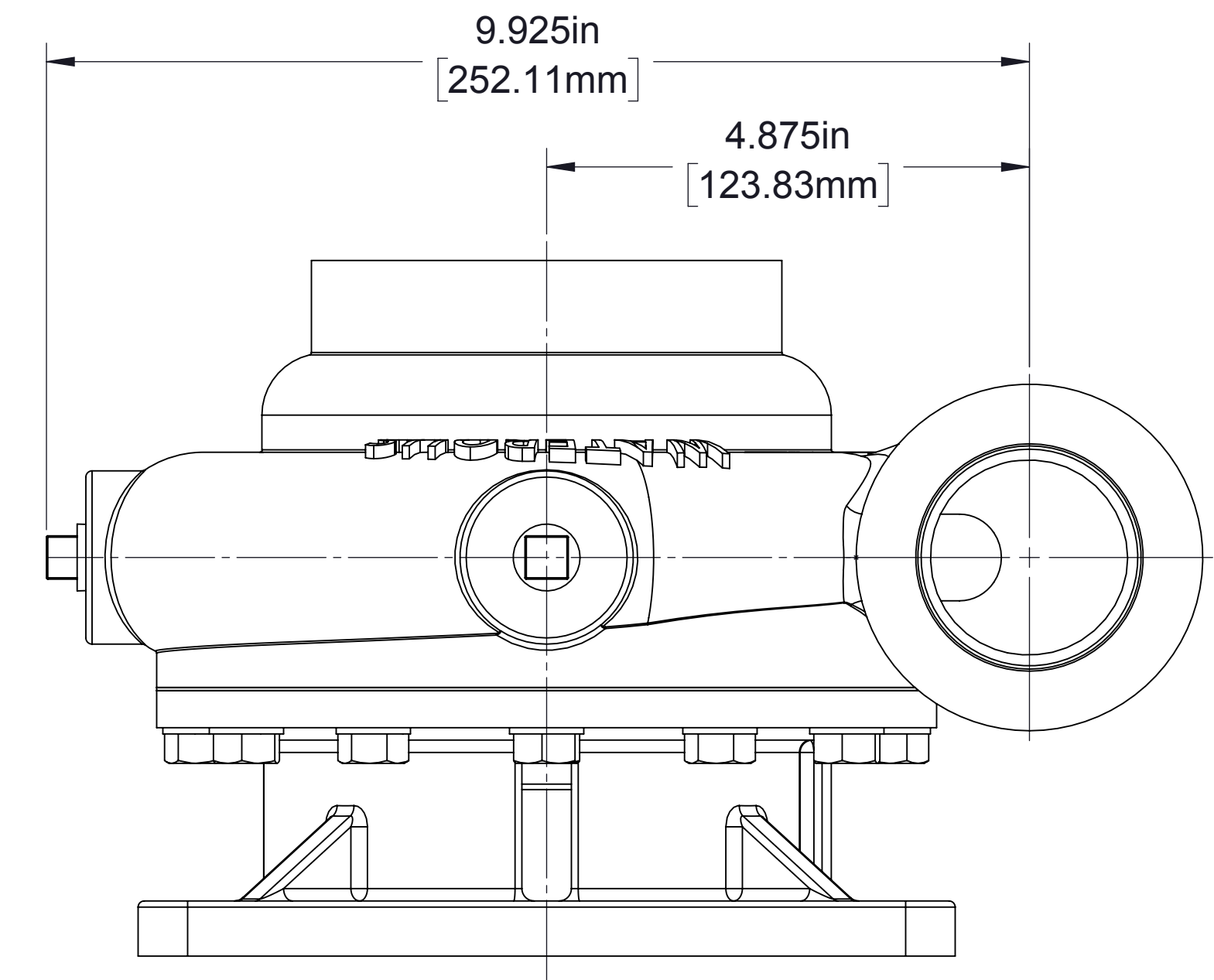
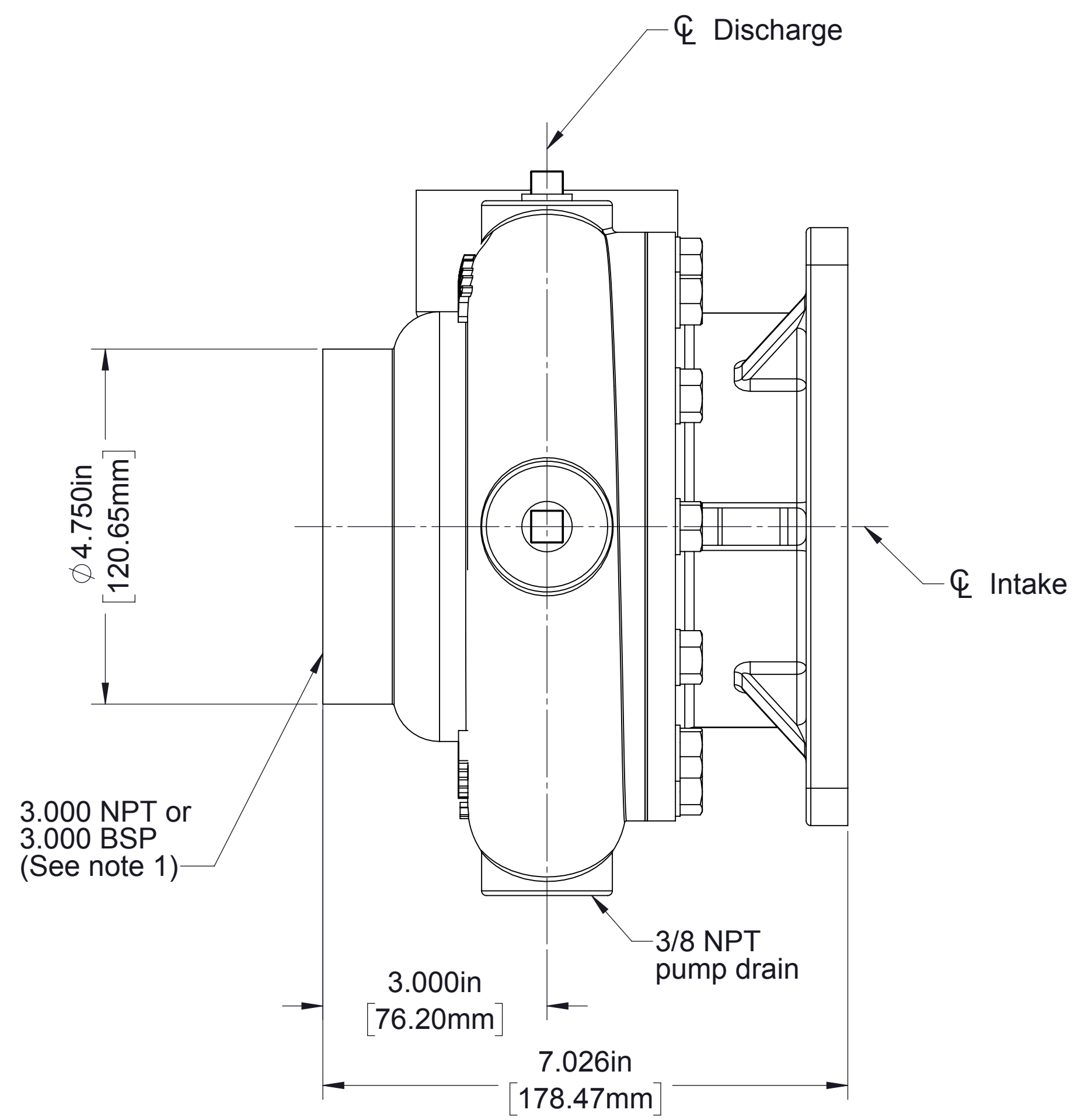
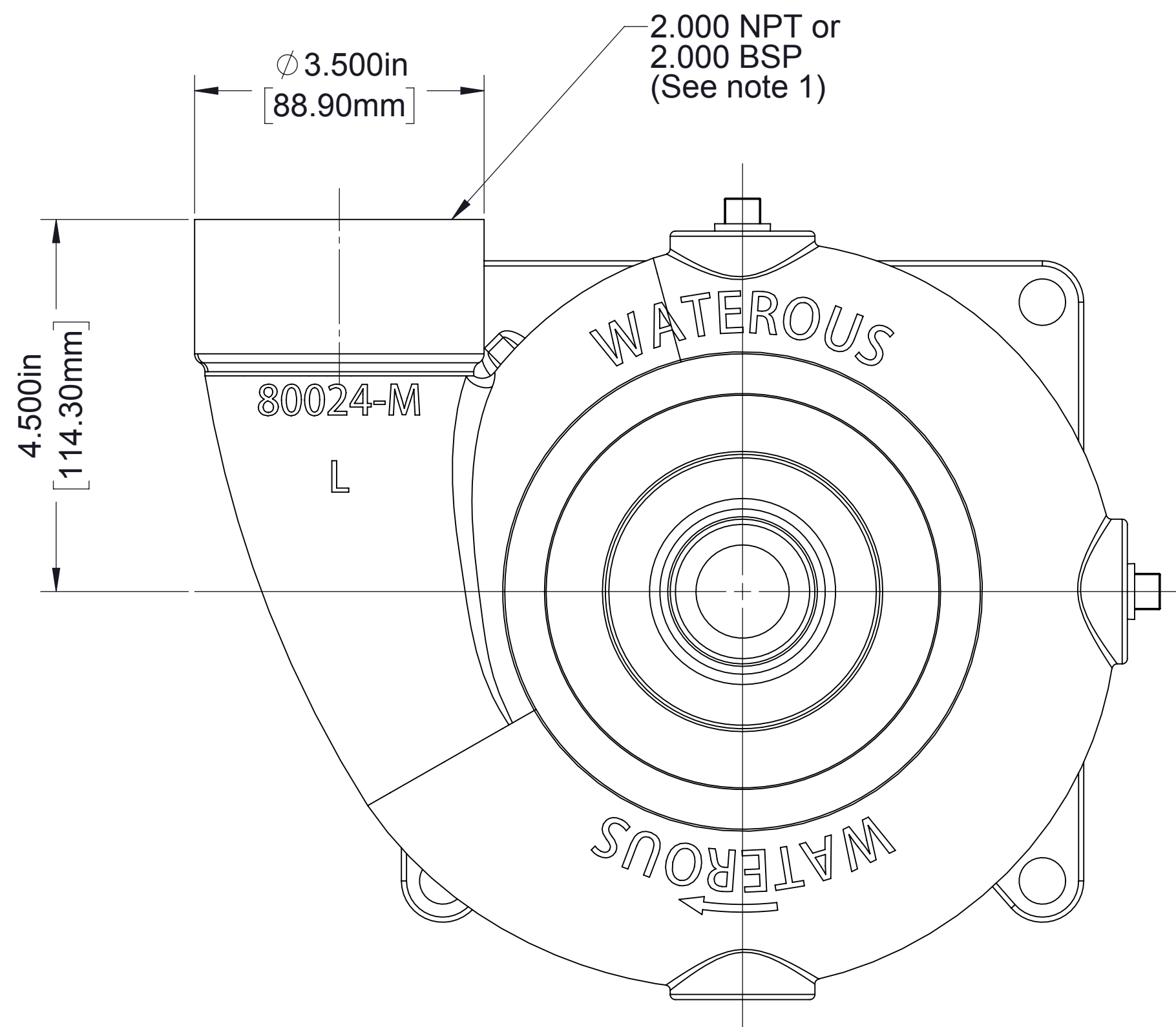

Model- CP-2
Basic Pump Dimensions
Clockwise Drive Shaft Rotation Input Shown

Note:
1. BSP (British Pipe) threads are available as straight or tapered. Straight threads are Per BS2779 for fittings where pressure-tight joints are made on the threads. Tapered threads are per BS21 for fittings where pressure-tight joints are made on the threads.

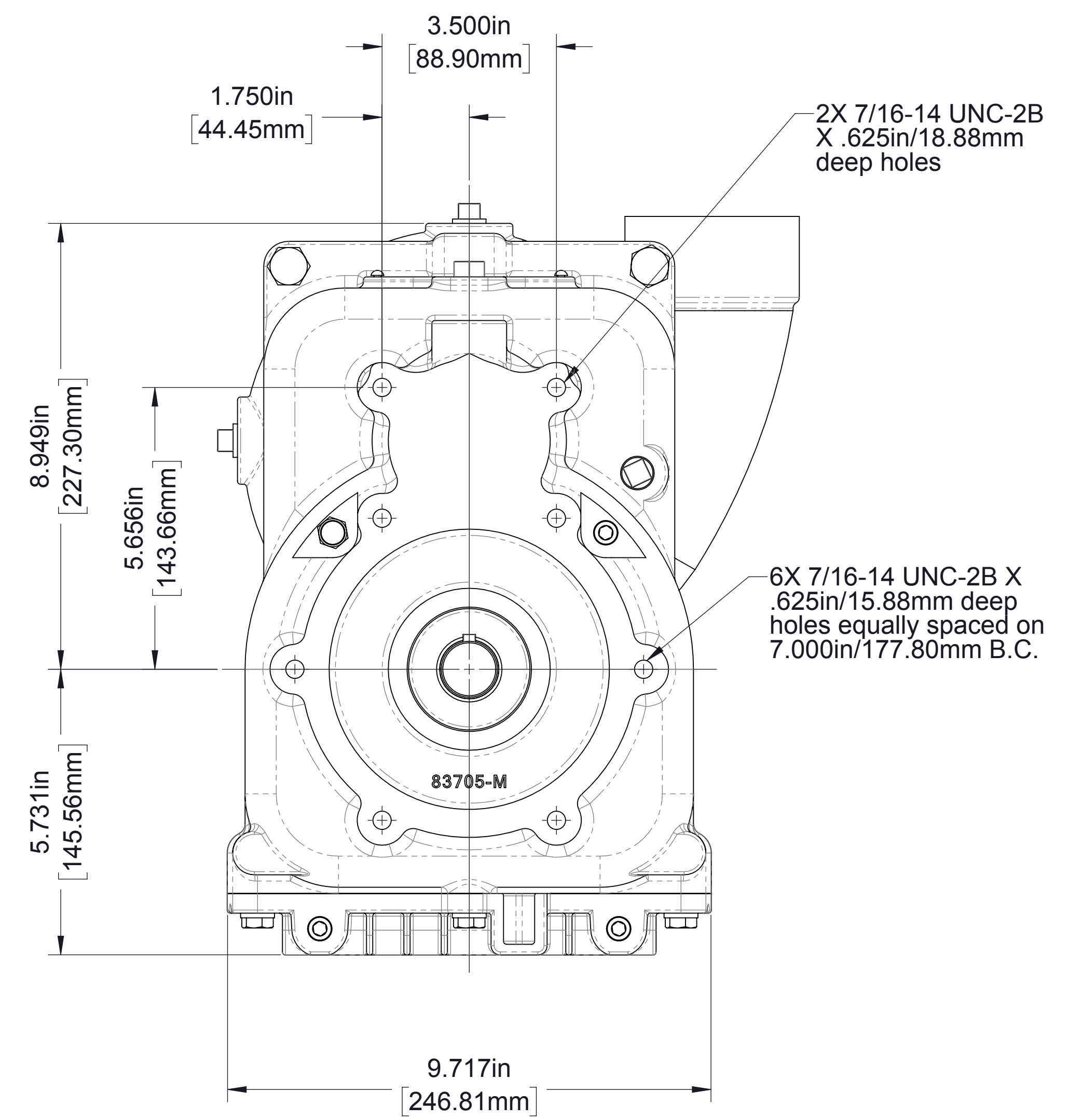
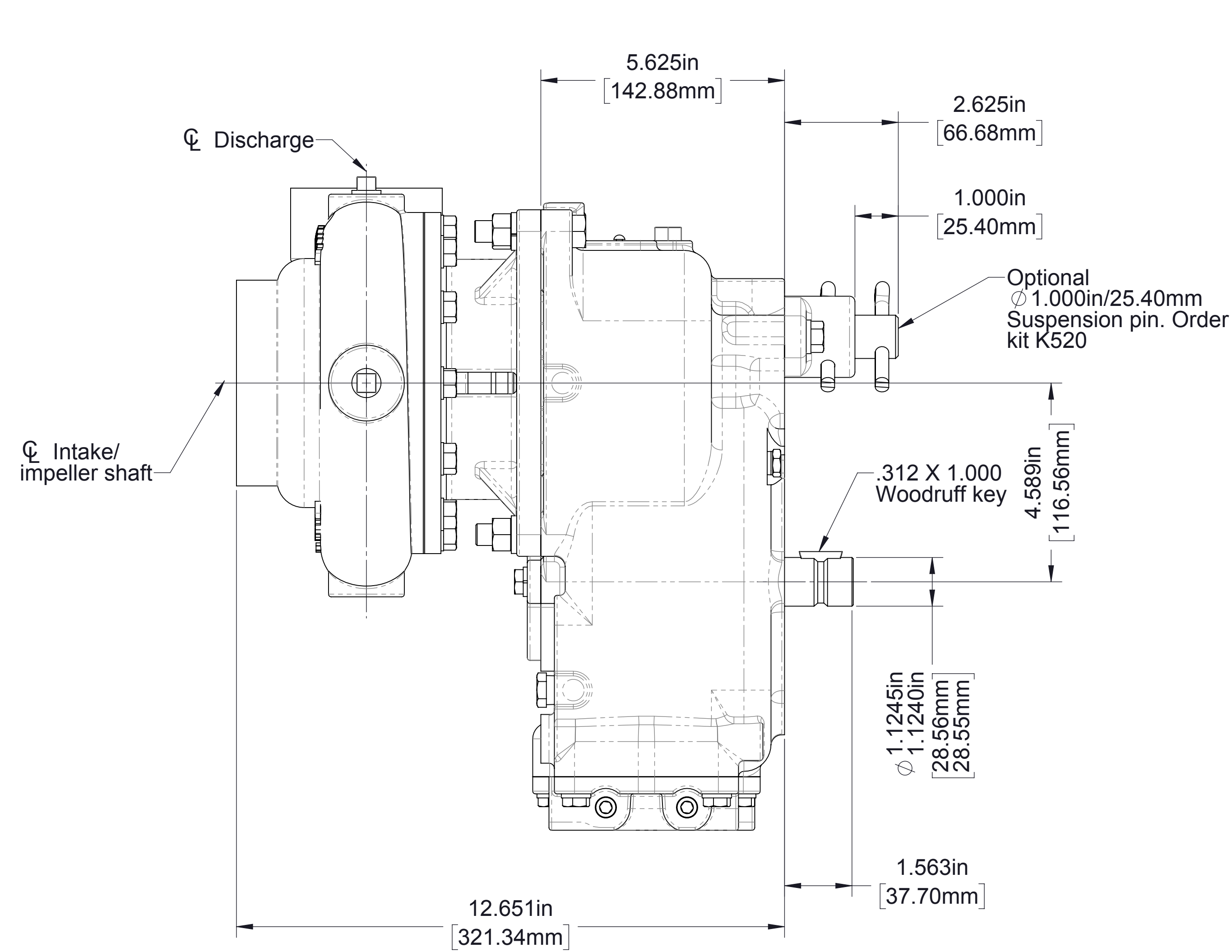

Model CPK-2
 Medium Duty K Transmission
 (Two Gear Without Clutch)
 Clockwise or Counterclockwise Input
 (Vertical Mounting Shown)

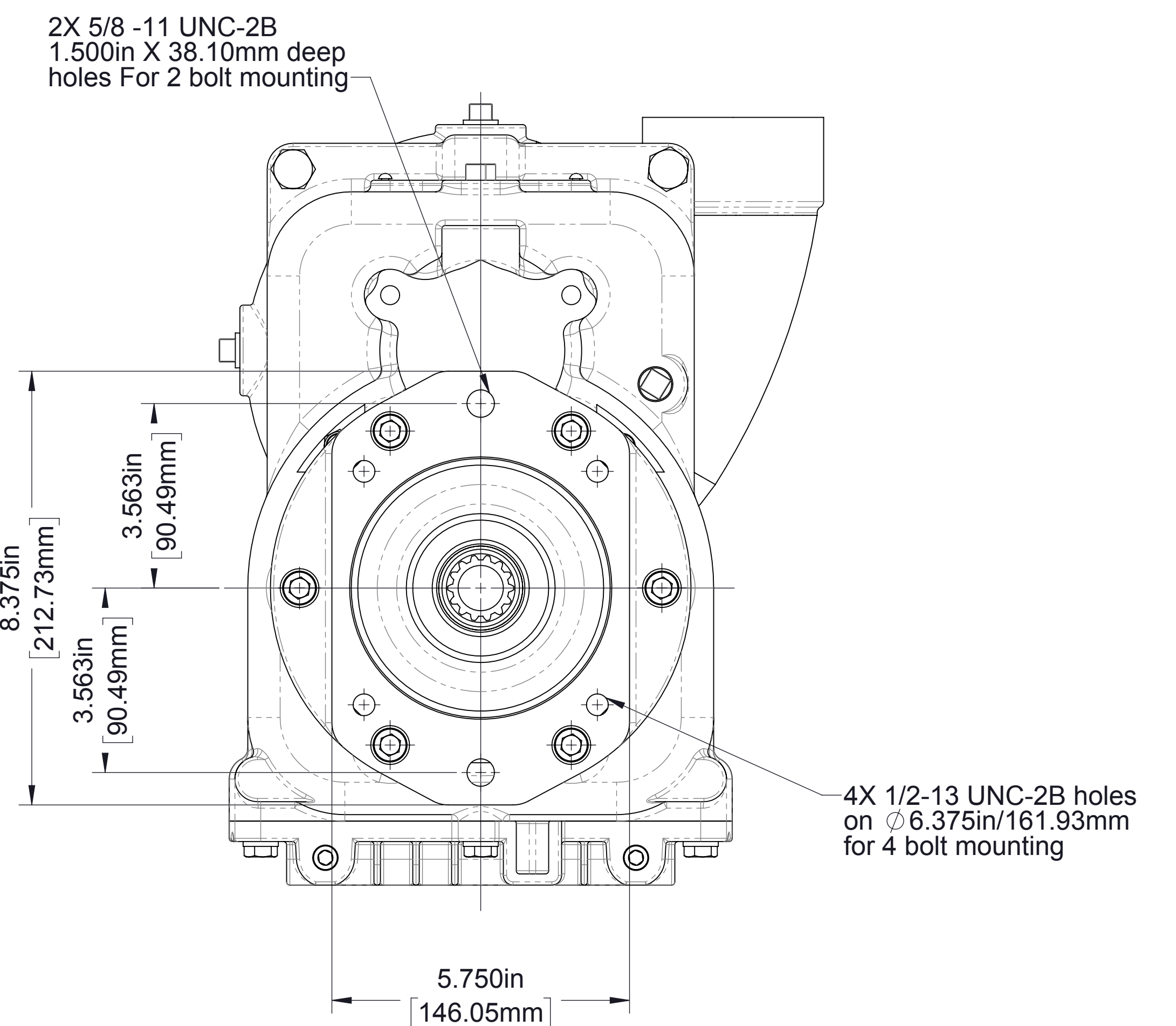
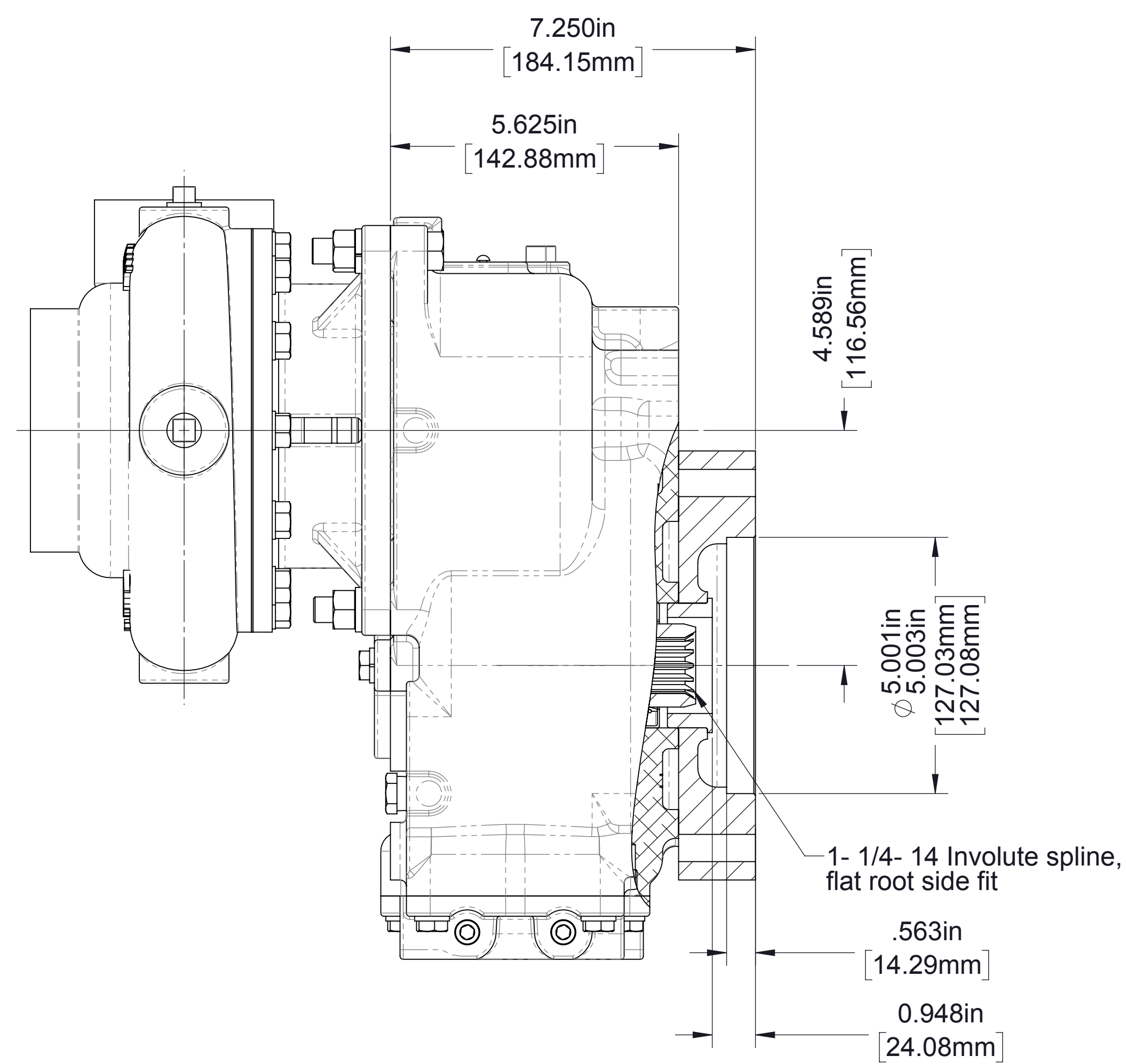

Optional SAE Class "C" 2 Or 4 Bolt
 Hydraulic Pump Flange Input For Medium
 Duty K Transmission
 (Available For Clockwise or Counter Clockwise Rotation)

(F) 3/8-16 UNC-2B
Tapped holes in
flywheel housing, use
class 5 screws

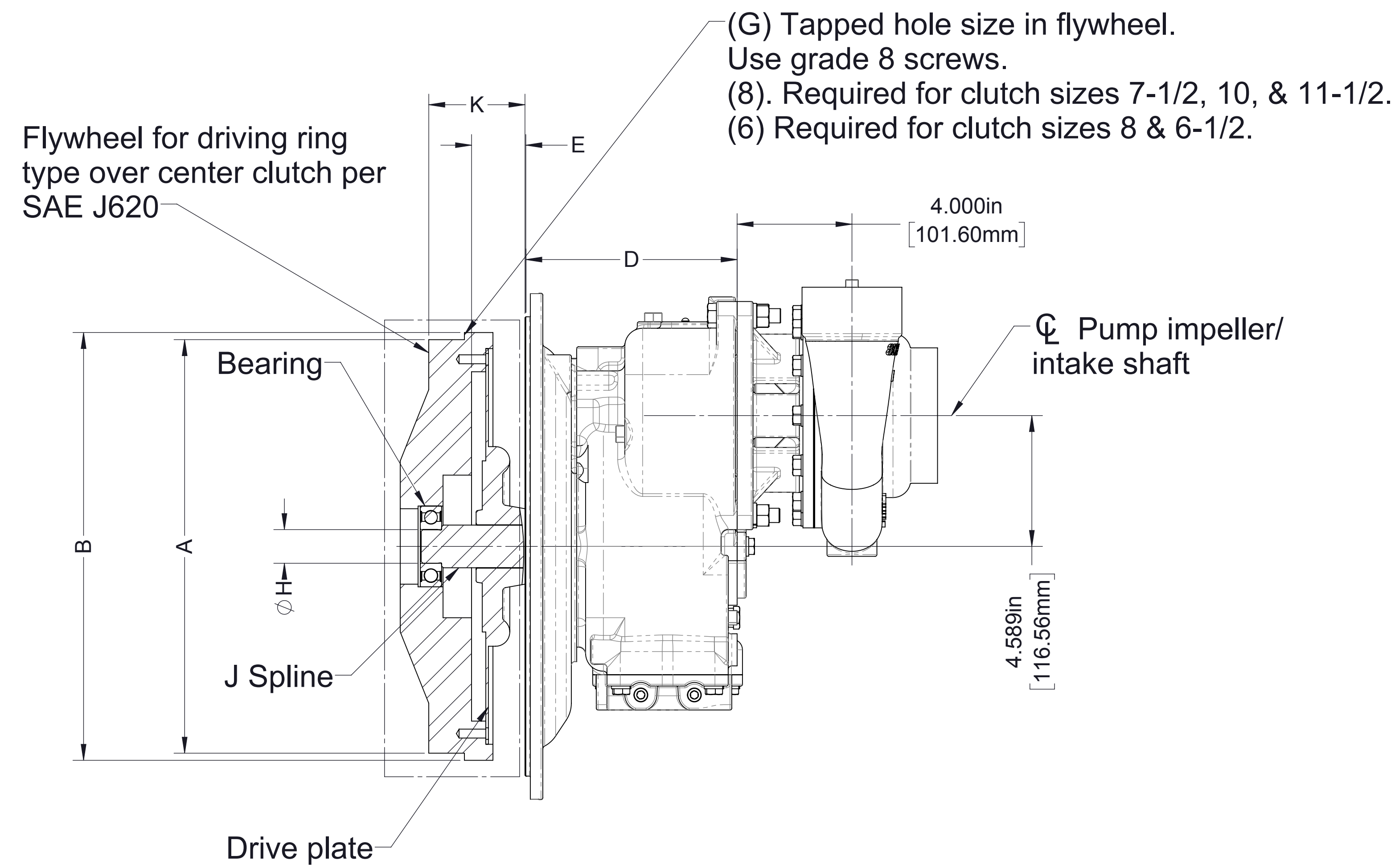
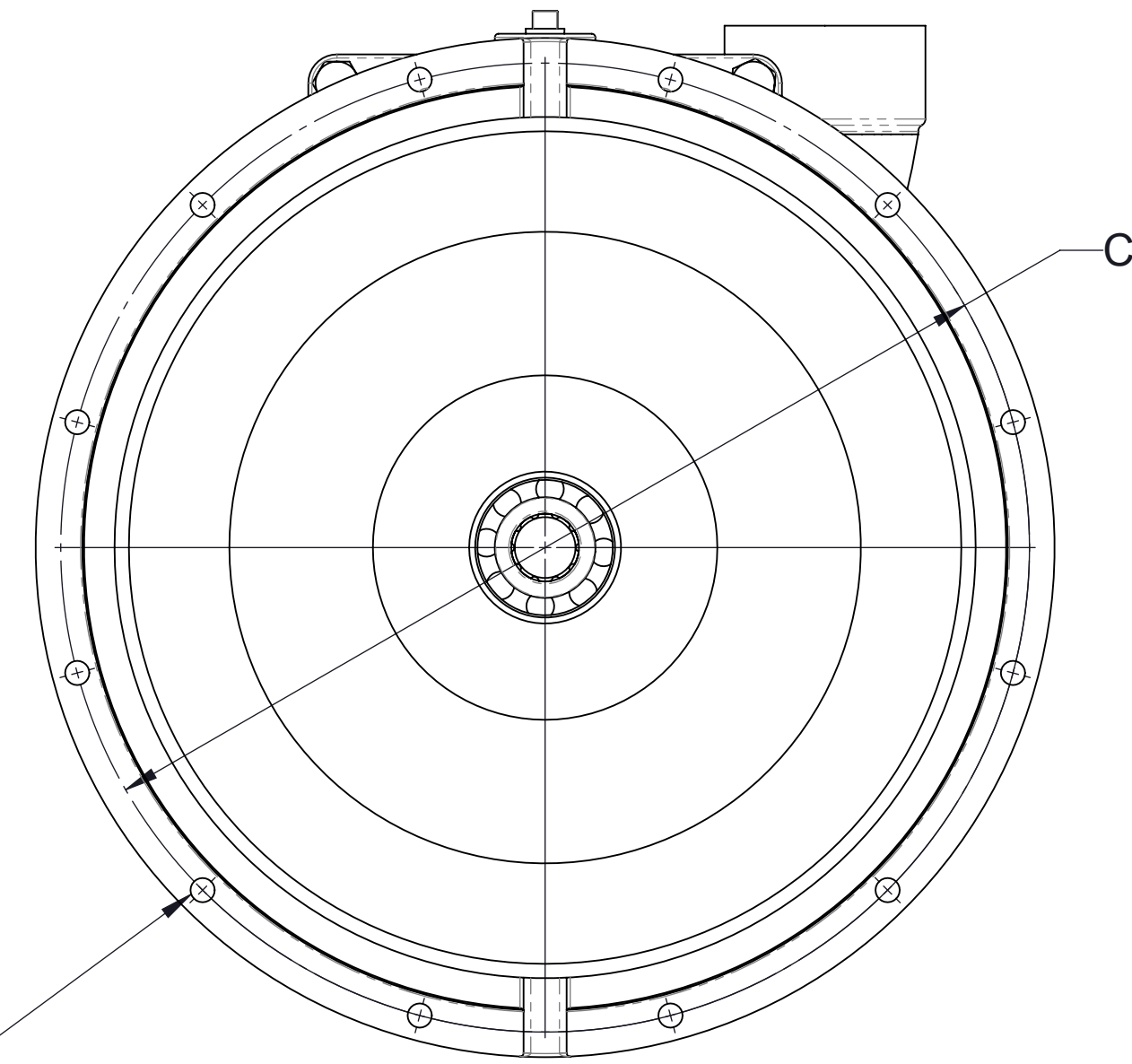

SAE Bellhousing					D	SAE Flywheel				Drive Plate		Drive Shaft	
Size	A	B	C	F		Clutch Number	E	G	K	Part Number	Torque Rating	H	J
3	16.125in 409.58mm	17.750in 450.85mm	16.875in 428.63mm	12	7.250in 184.15mm	10	2.120in 53.85mm	3/8-16	3.940in 100.08mm	V2272	850 FT-LB 1152.6 Joules	1.1805in <u>1.1800in</u> 29.98mm 29.97mm	1-1/2-10 S.A.E
4	14.250in 361.95mm	15.875in 403.23mm	15.000in 381.00mm			11-1/2	15.600in 39.62mm			V2461	425 FT-LB 576.3 Joules		
3	16.125in 409.58mm	17.750in 450.85mm	16.875in 428.63mm			8	2.440in 61.97mm			V2852	N/A		
4	14.250in 361.95mm	15.875in 403.23mm	15.000in 381.00mm			7-1/2	1.190in 30.23mm	5/16-18	2.810in 71.40mm	V4128	N/A	.7868in <u>.7858in</u> 19.98mm 19.96mm	1-15T Involute
5	12.375in 314.32mm	14.000in 355.60mm	13.125in 333.38mm	8	6.250in 158.75mm	6-1/2				V2865	N/A		

Model CPT-2
Medium Duty T Transmission
(Two Gear Without Clutch)
Clockwise or Counterclockwise Input
(Vertical Mounting Position Shown)

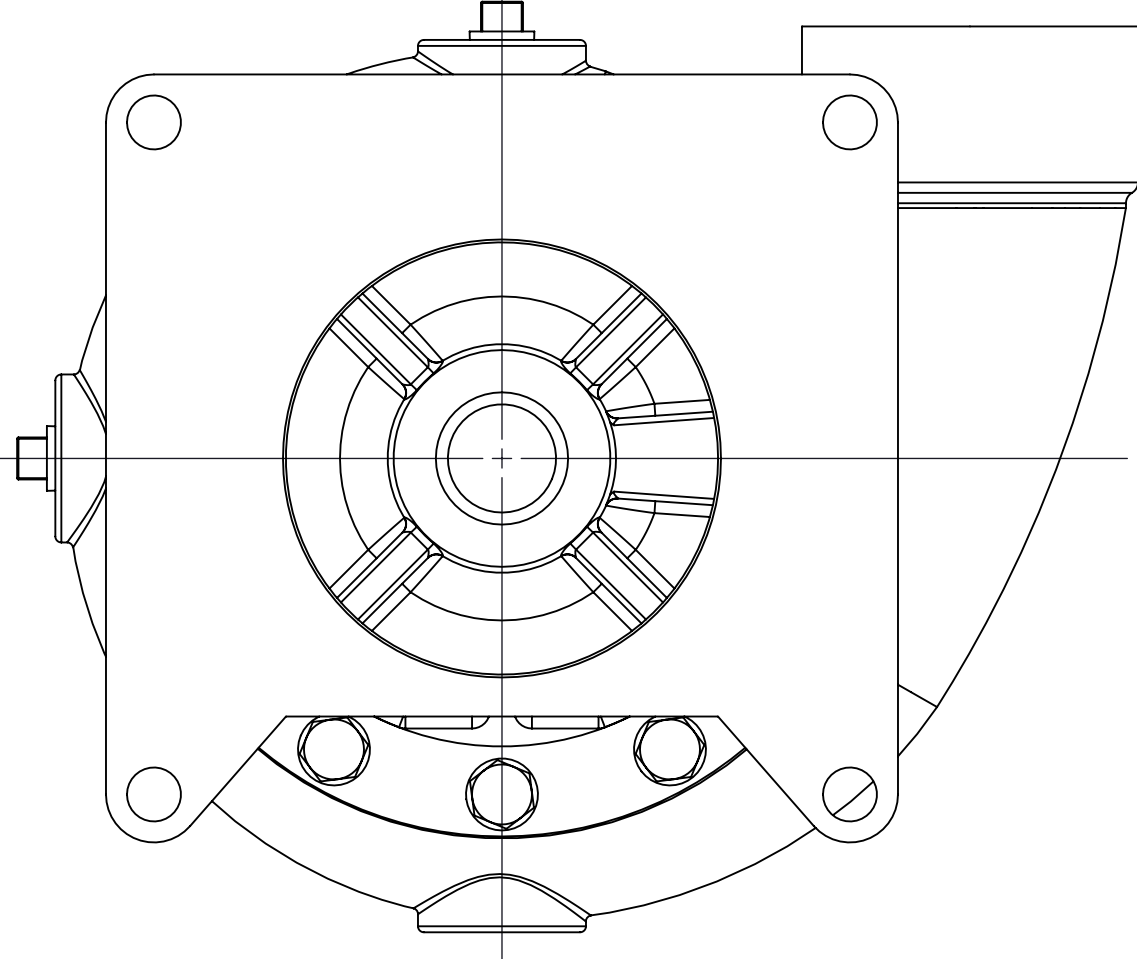
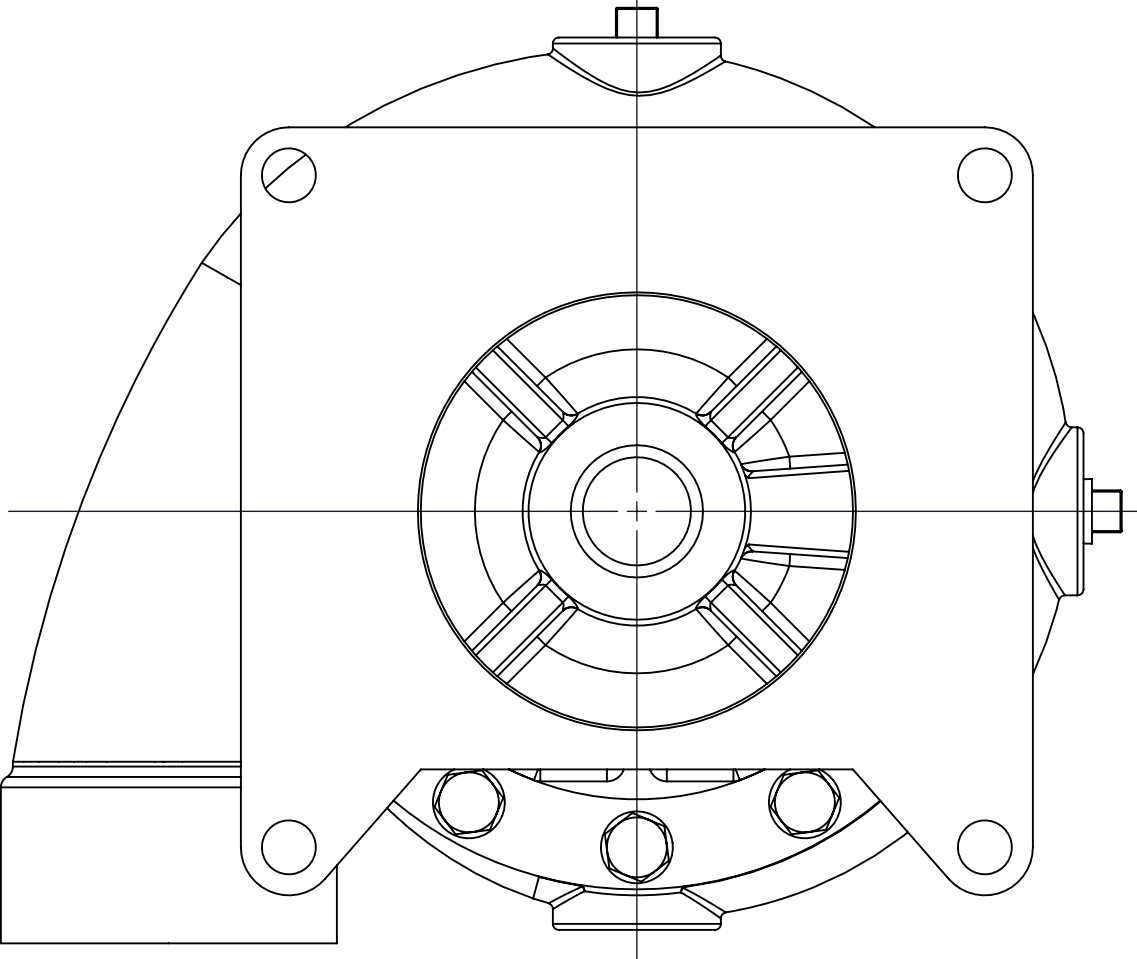
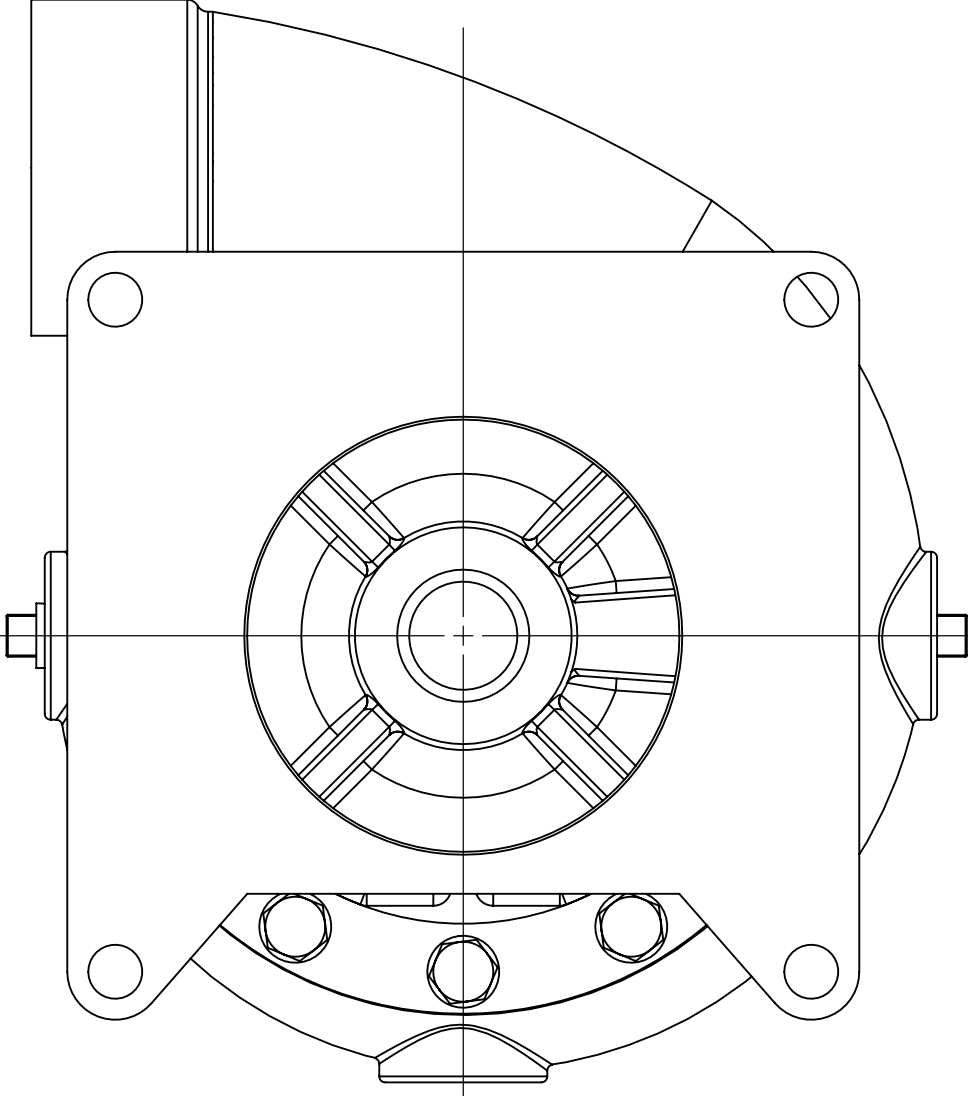
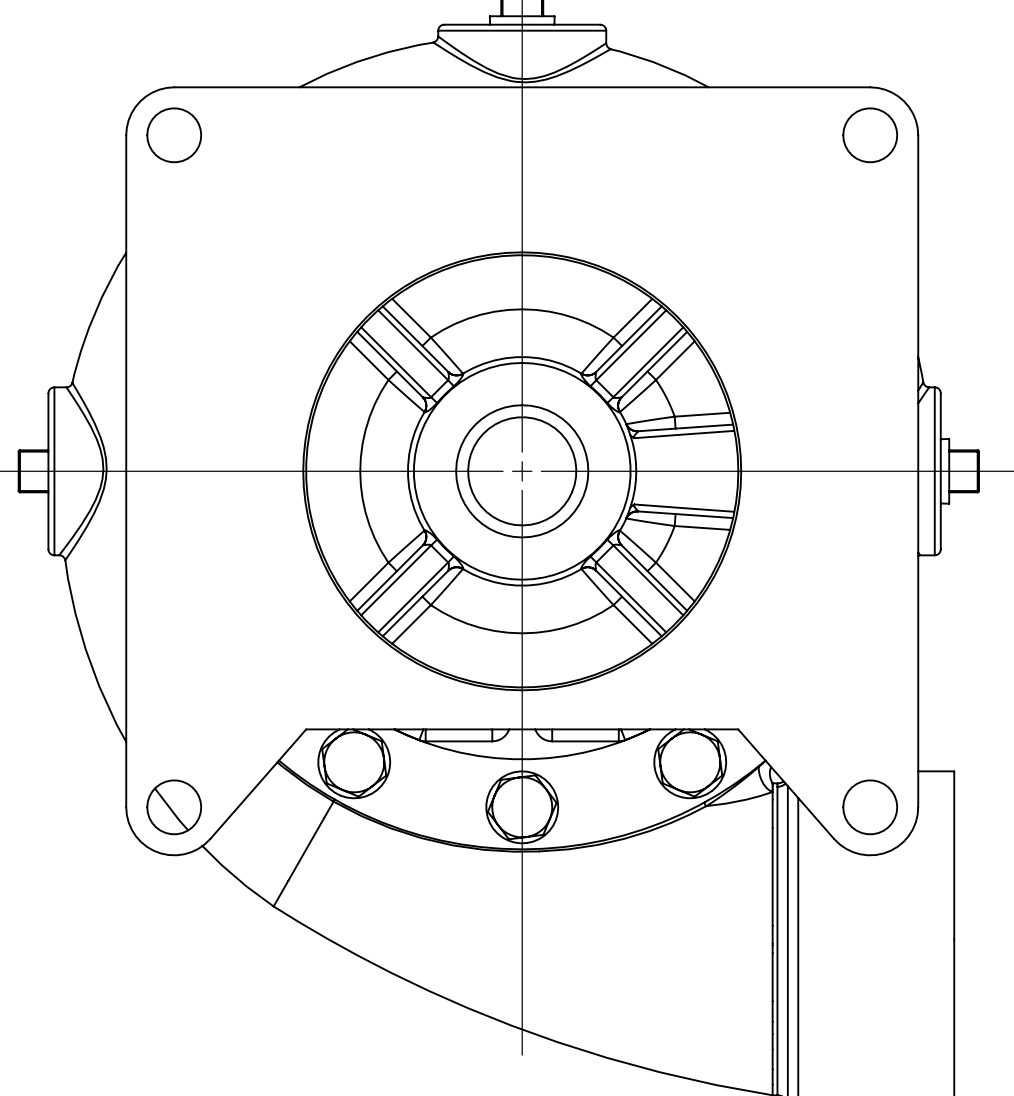
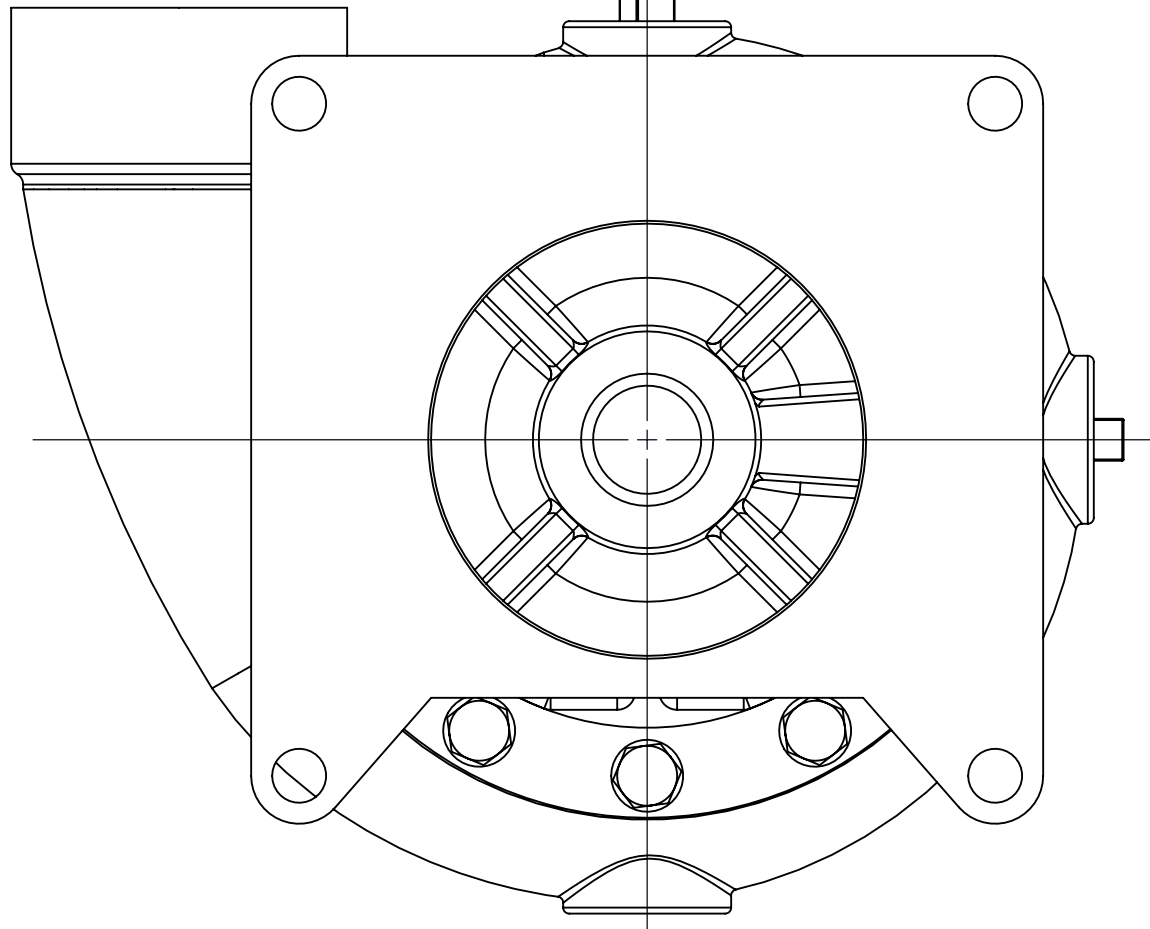
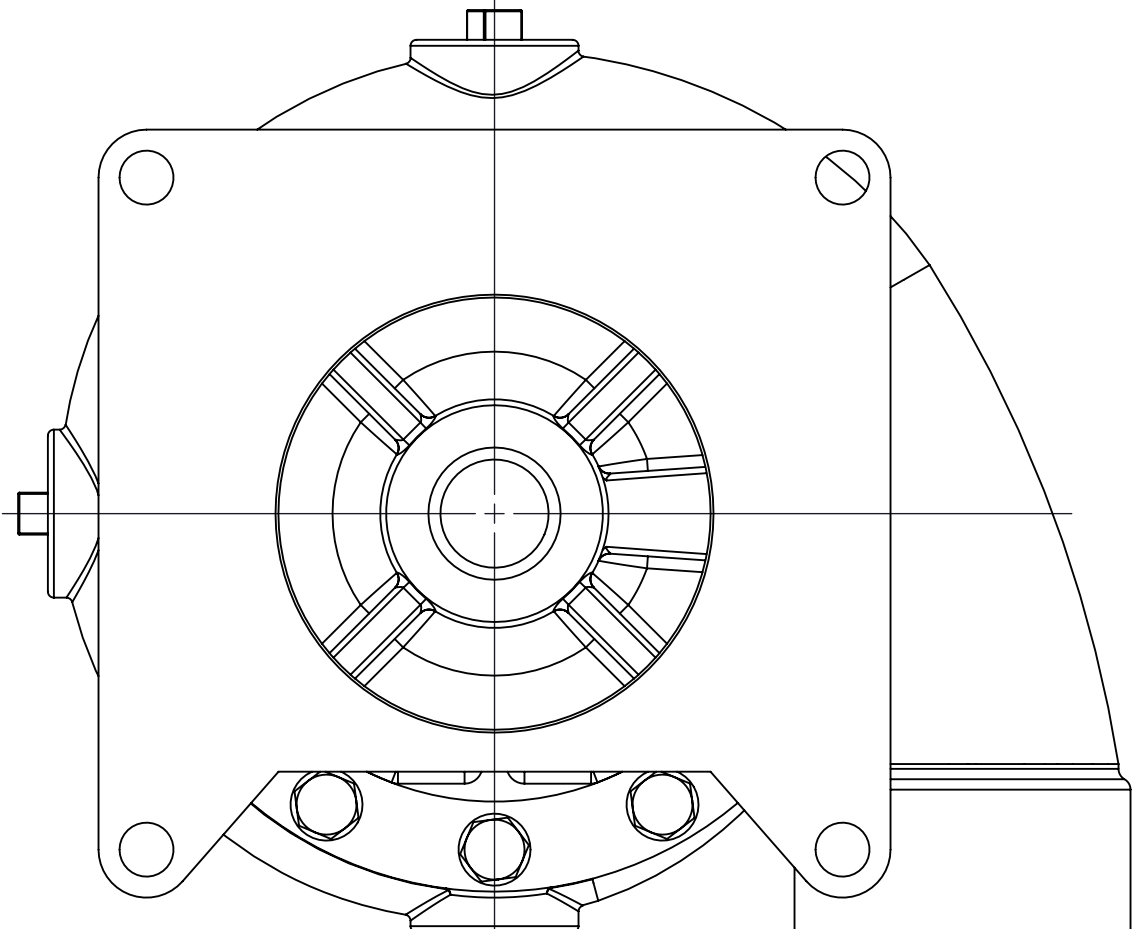
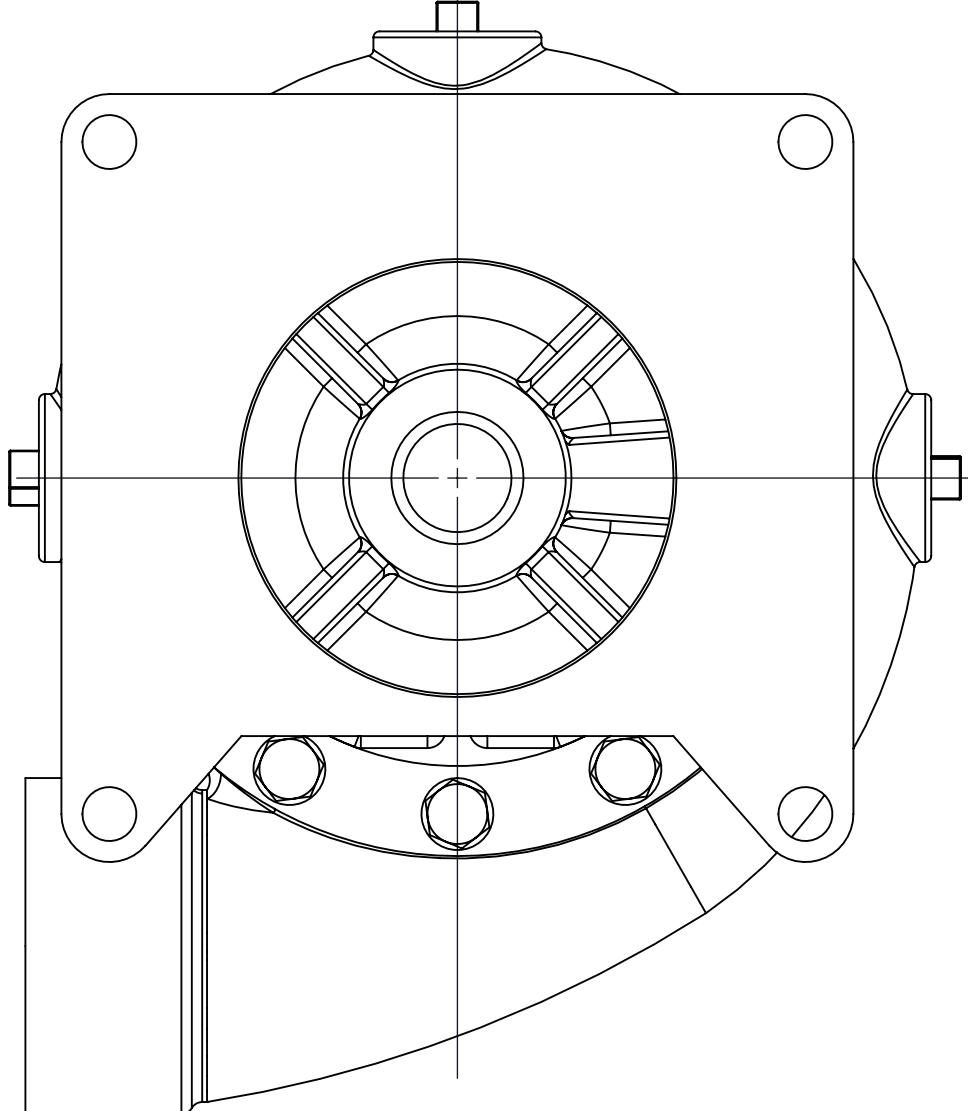
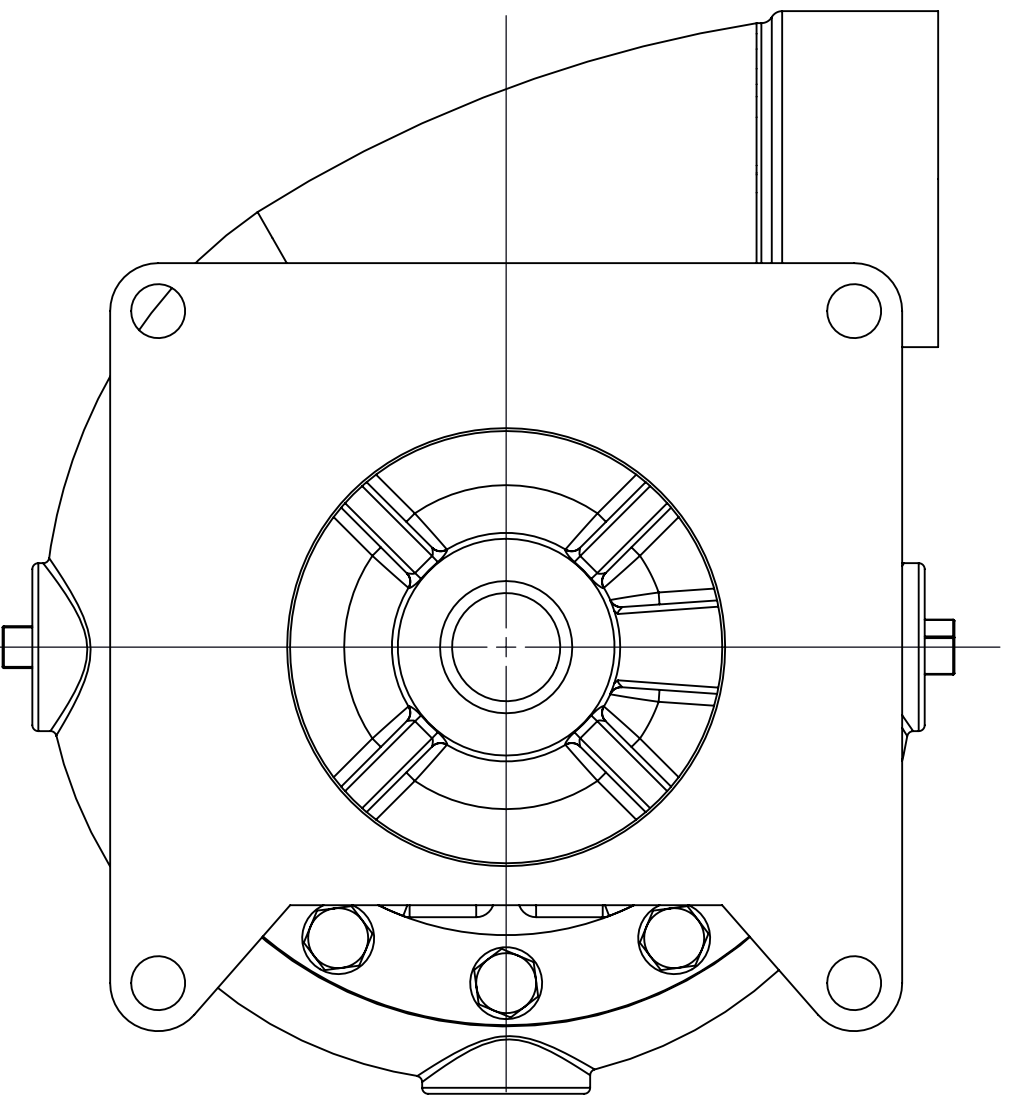
Input Rotation(1)	Up	Down	Left	Right
CW				
CCW				

Note:

1. Input rotation is viewed looking at transmission input shaft.

Available Pump Mounting Positions K and T Transmissions

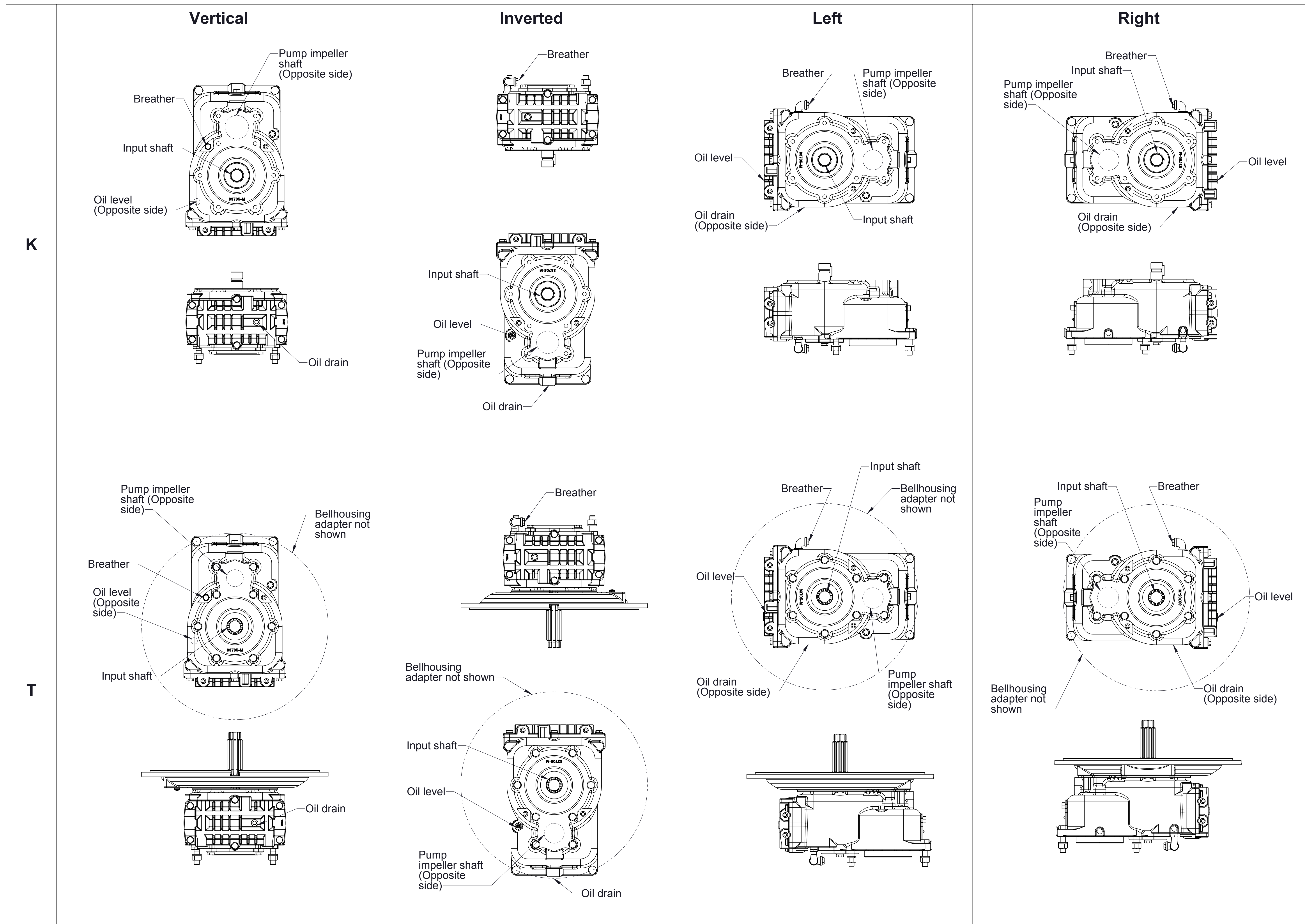

**Available Transmission Mounting Positions
as Viewed From Transmission Input Shaft**