

Venturis Air Primer Dimensional Drawings

Mounting	Transmission Model	See Sheet	
		Air Primer	Panel Activation
On the Transmission or PTO by Waterous	C20, C21, C22, C23 Series	2	5
	TC20, TC21, TC22, TC23 Series PTO	3	
By the OEM	All	4	

For Priming Valve Dimensions, see DPL82908

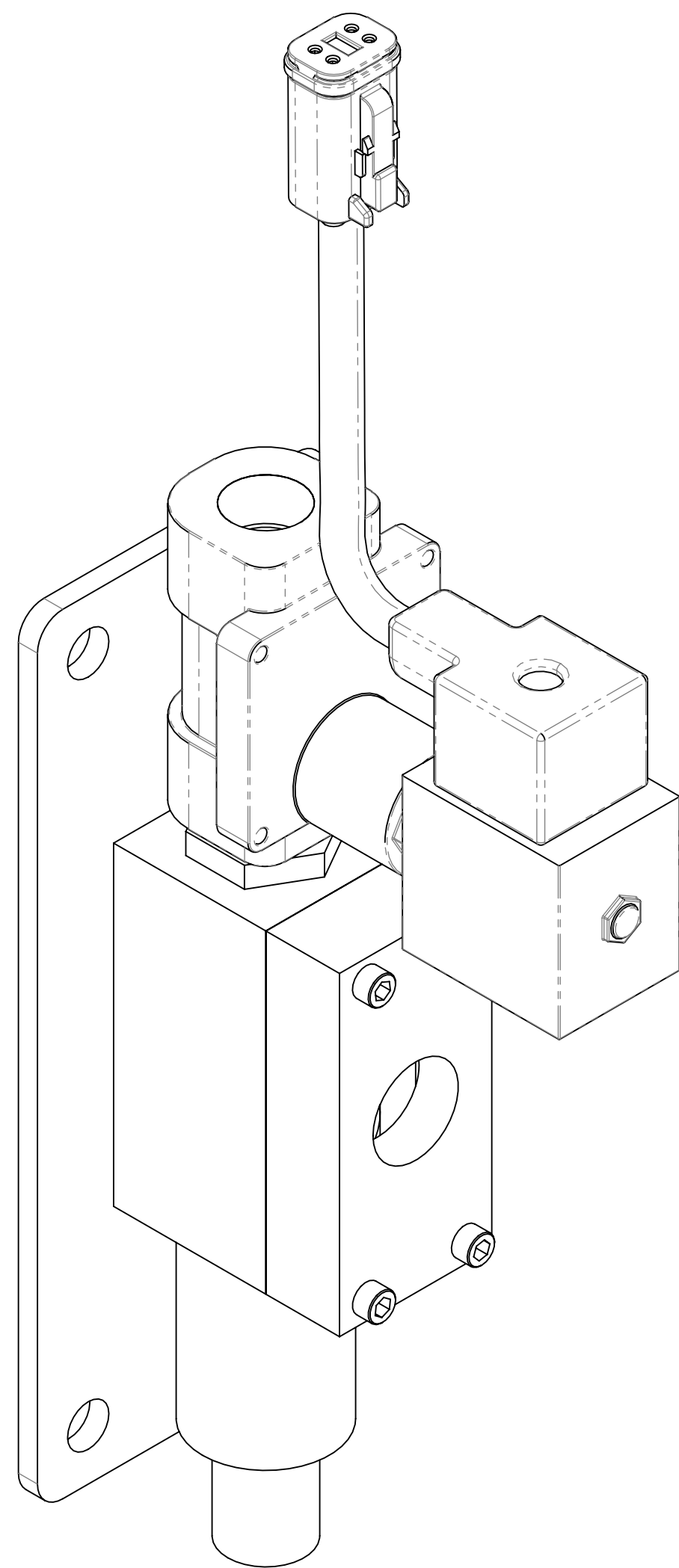

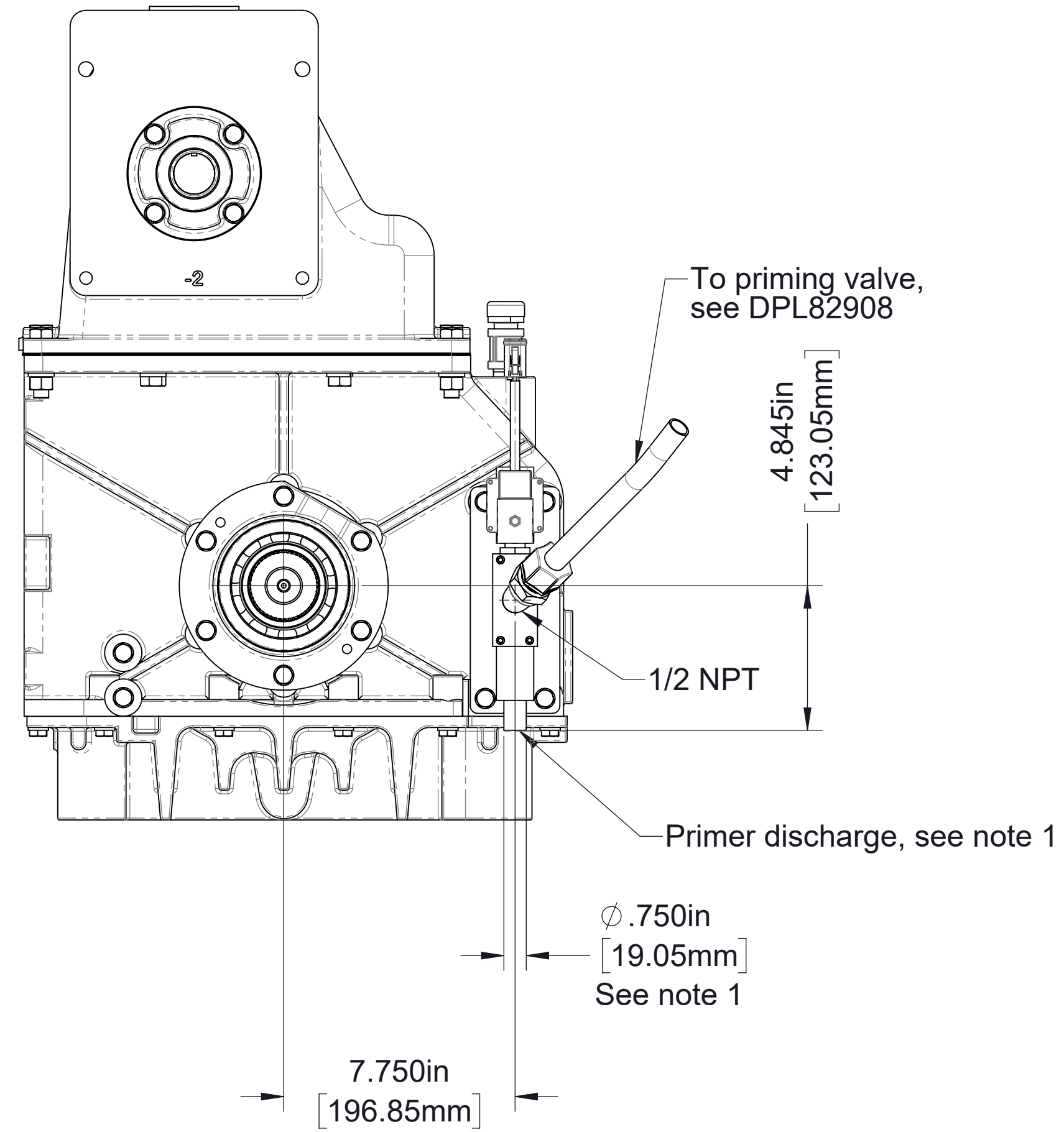
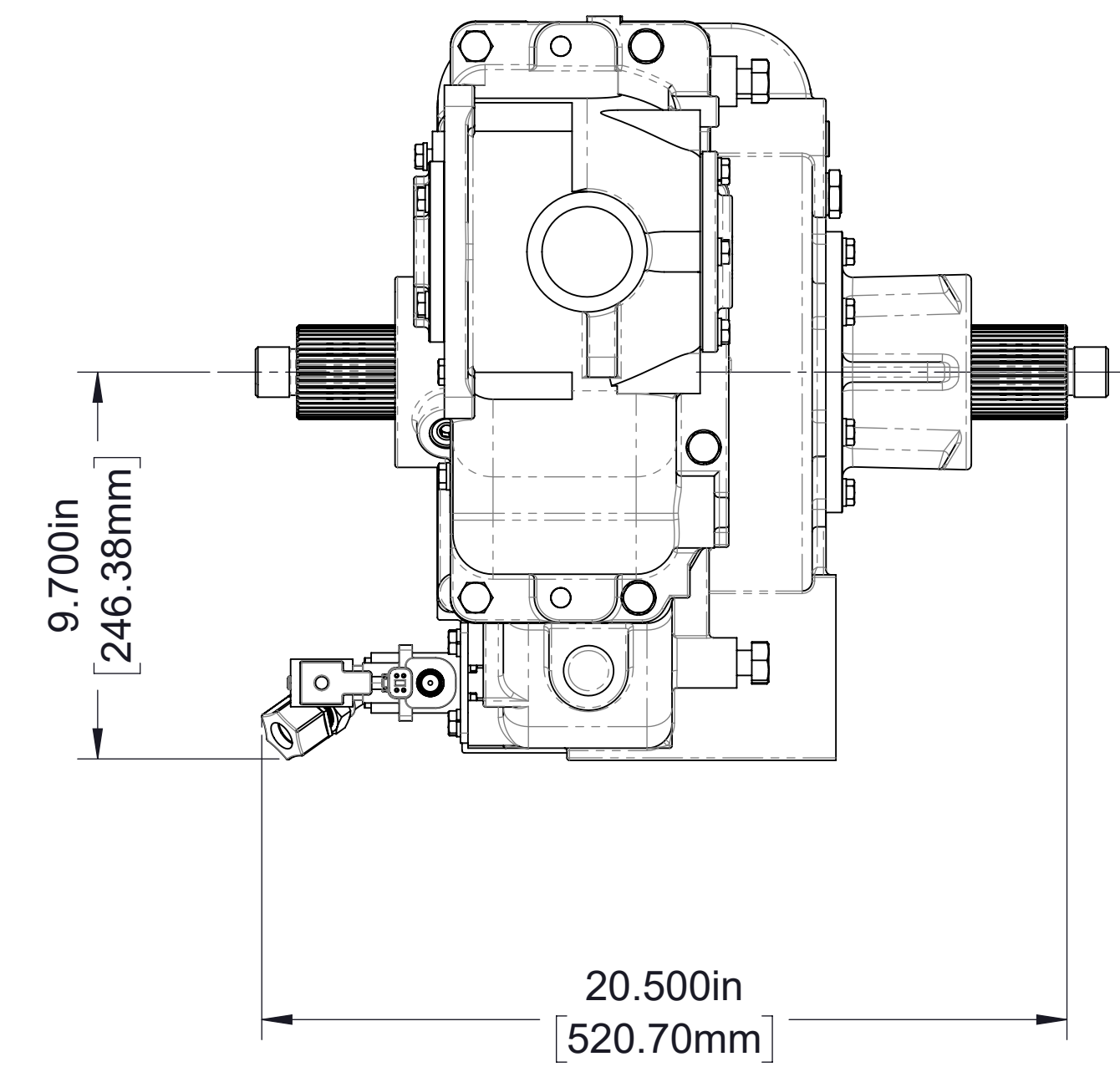

16.40 ft (5 meter)
Solenoid cable (furnished)

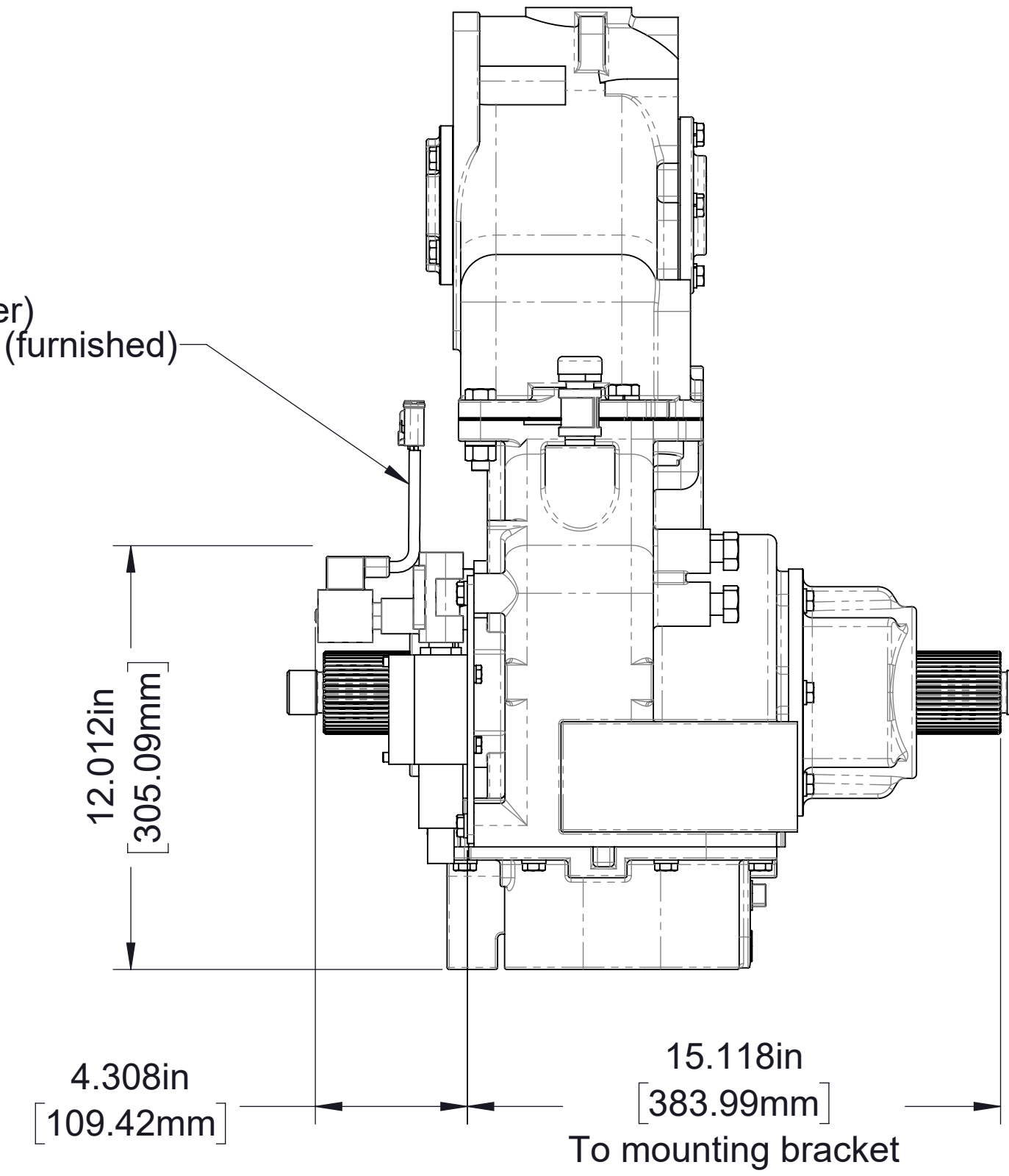

C20, C21, C22, C23 Series Transmission

Note:
1. OEM may attach a 3/4 in I.D. hose to air primer
to direct exhaust to a more suitable location.
Make sure flow is not impeded.

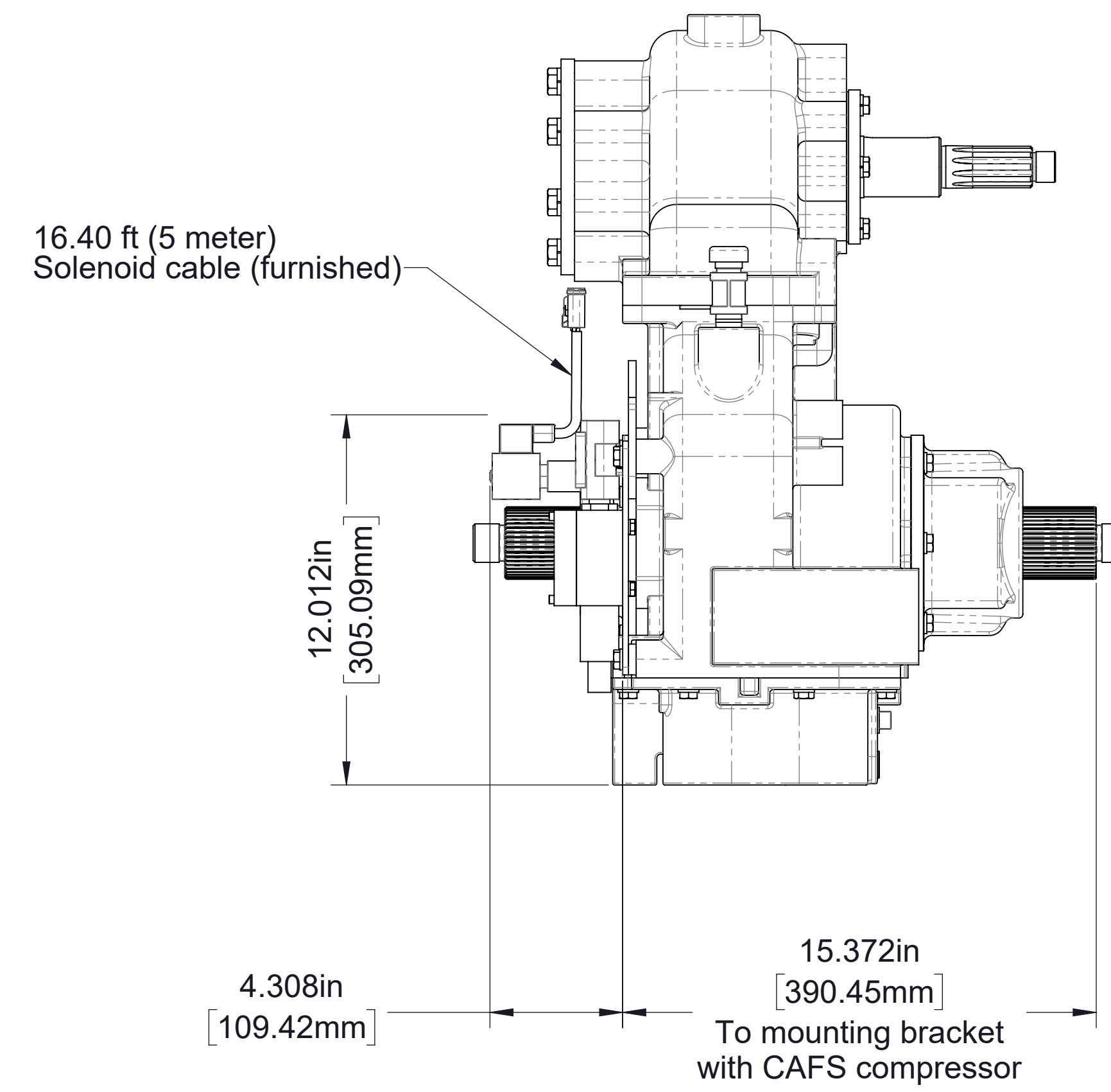
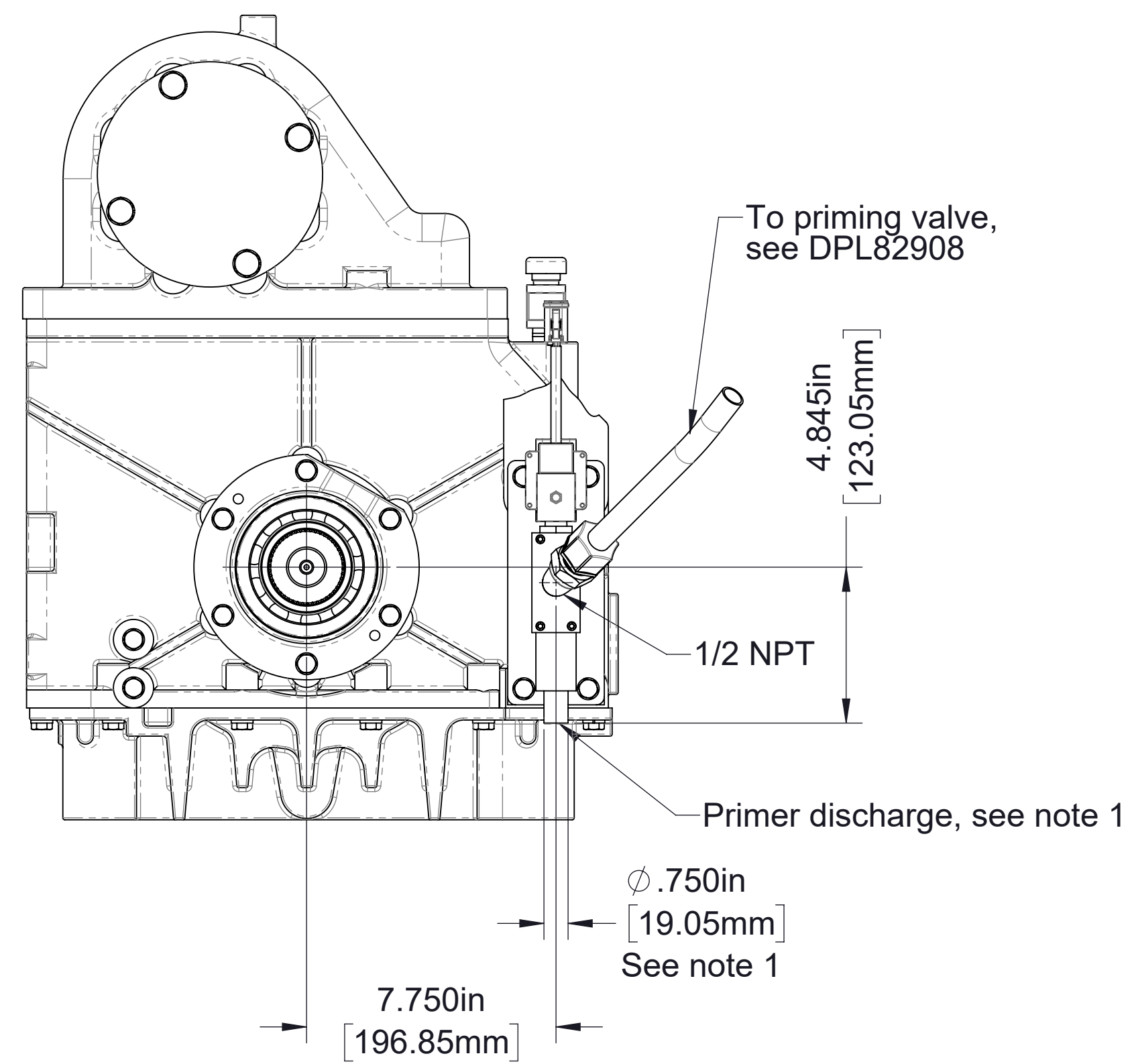
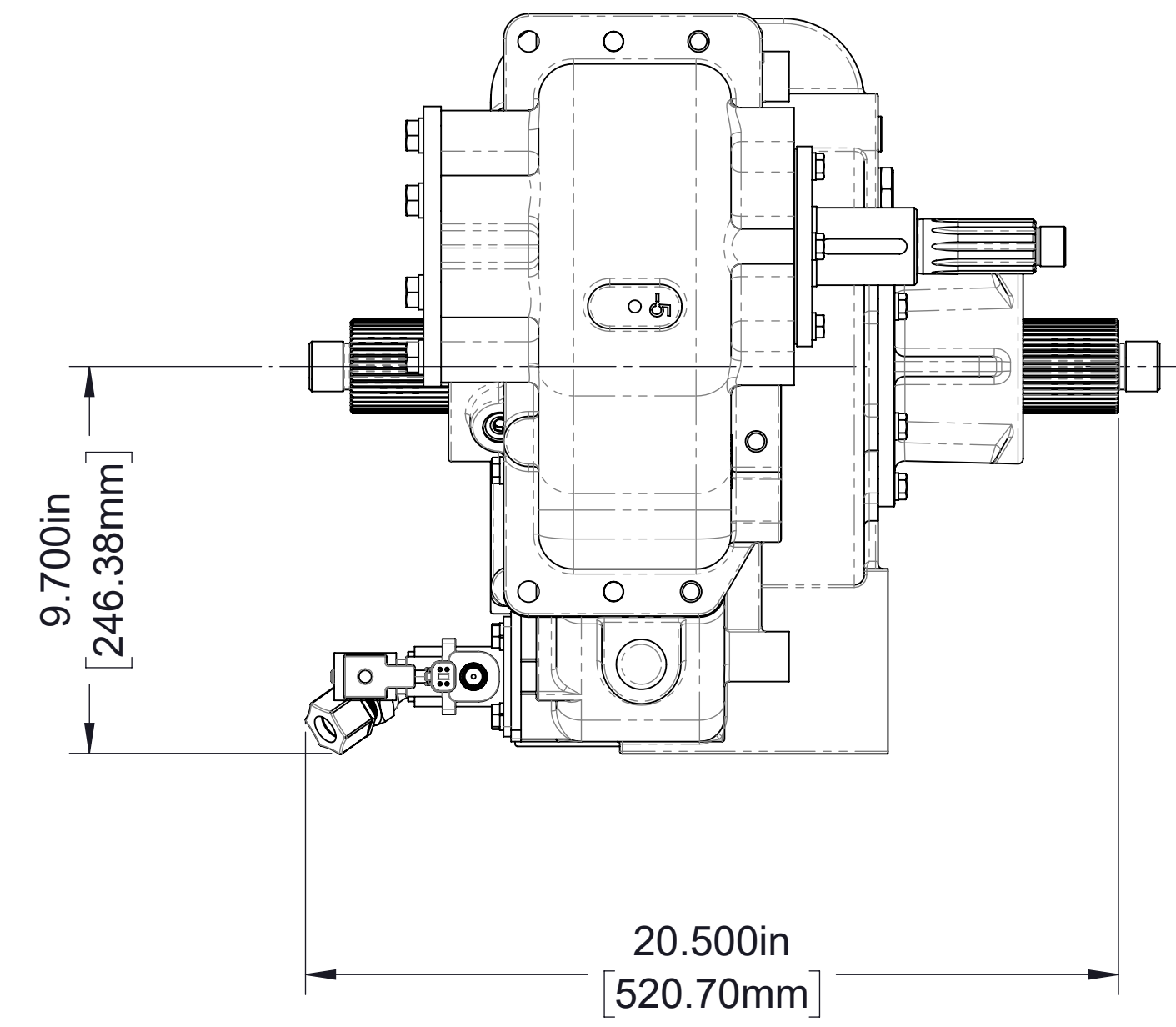

TC20, TC21, TC22, TC23 Series PTO

Note:
1. OEM may attach a 3/4 in I.D. hose to air primer to direct exhaust to a more suitable location. Make sure flow is not impeded.

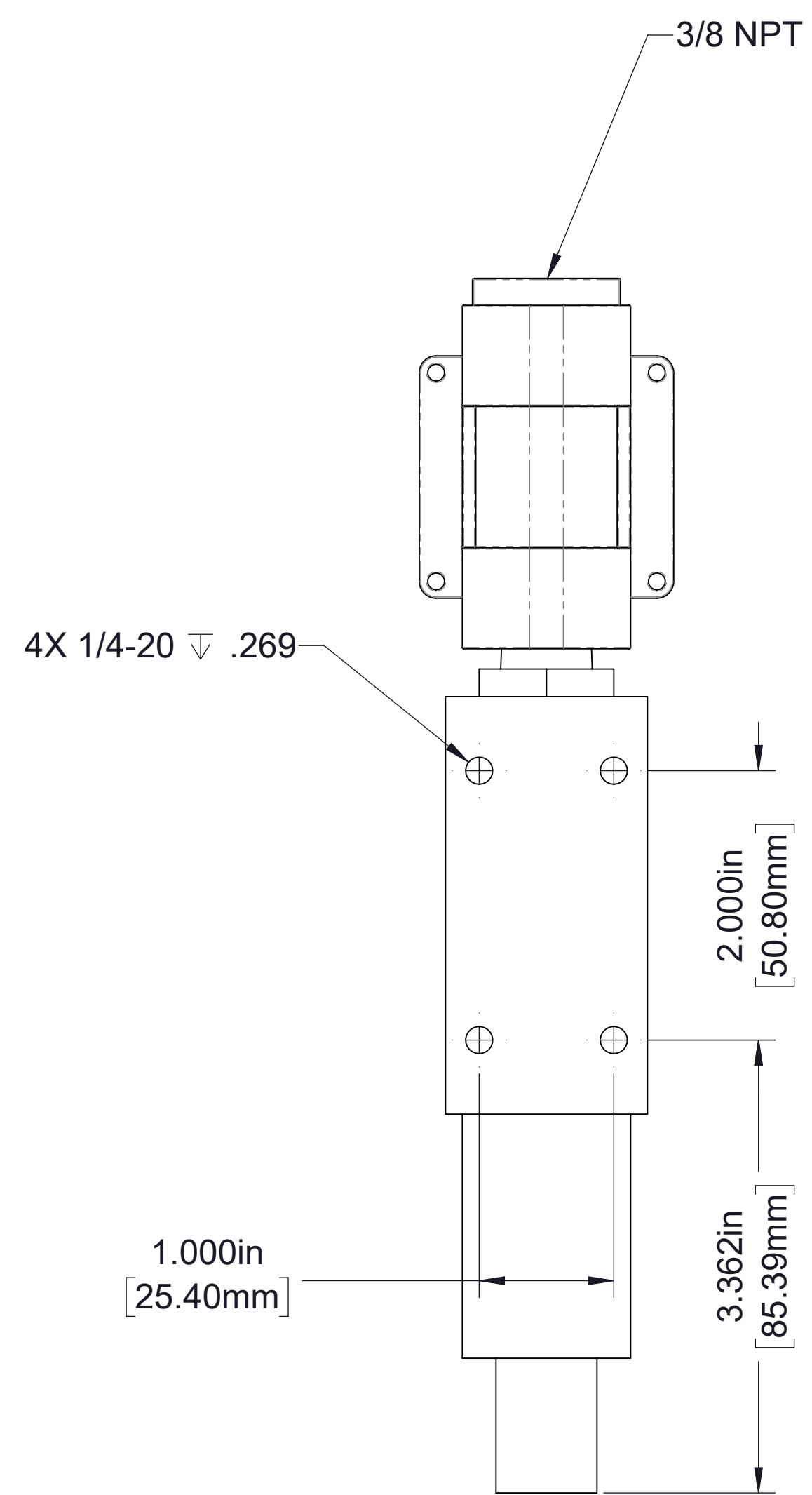

Up

Air Primer must be mounted in this orientation to allow for proper drainage

Down

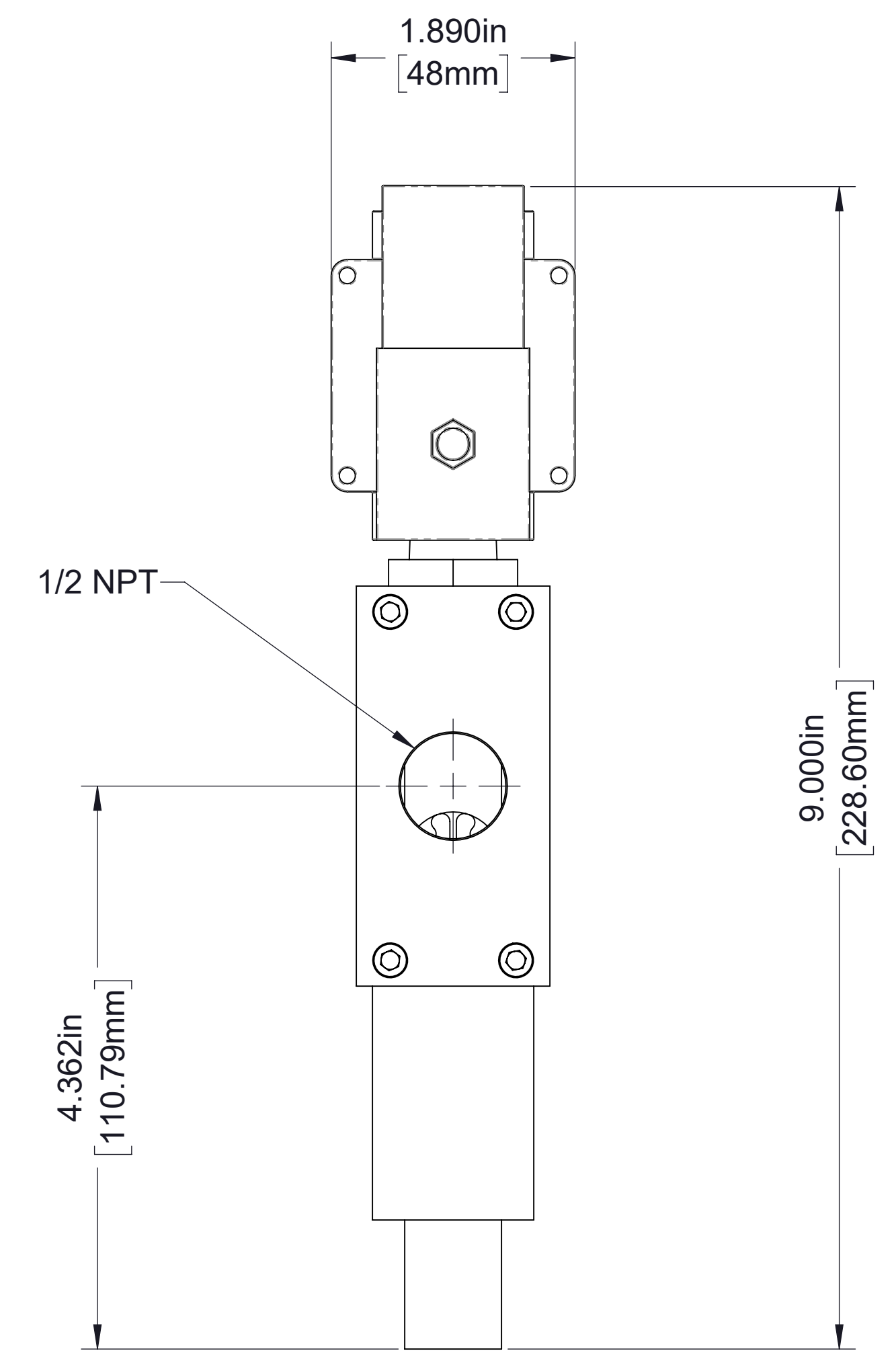
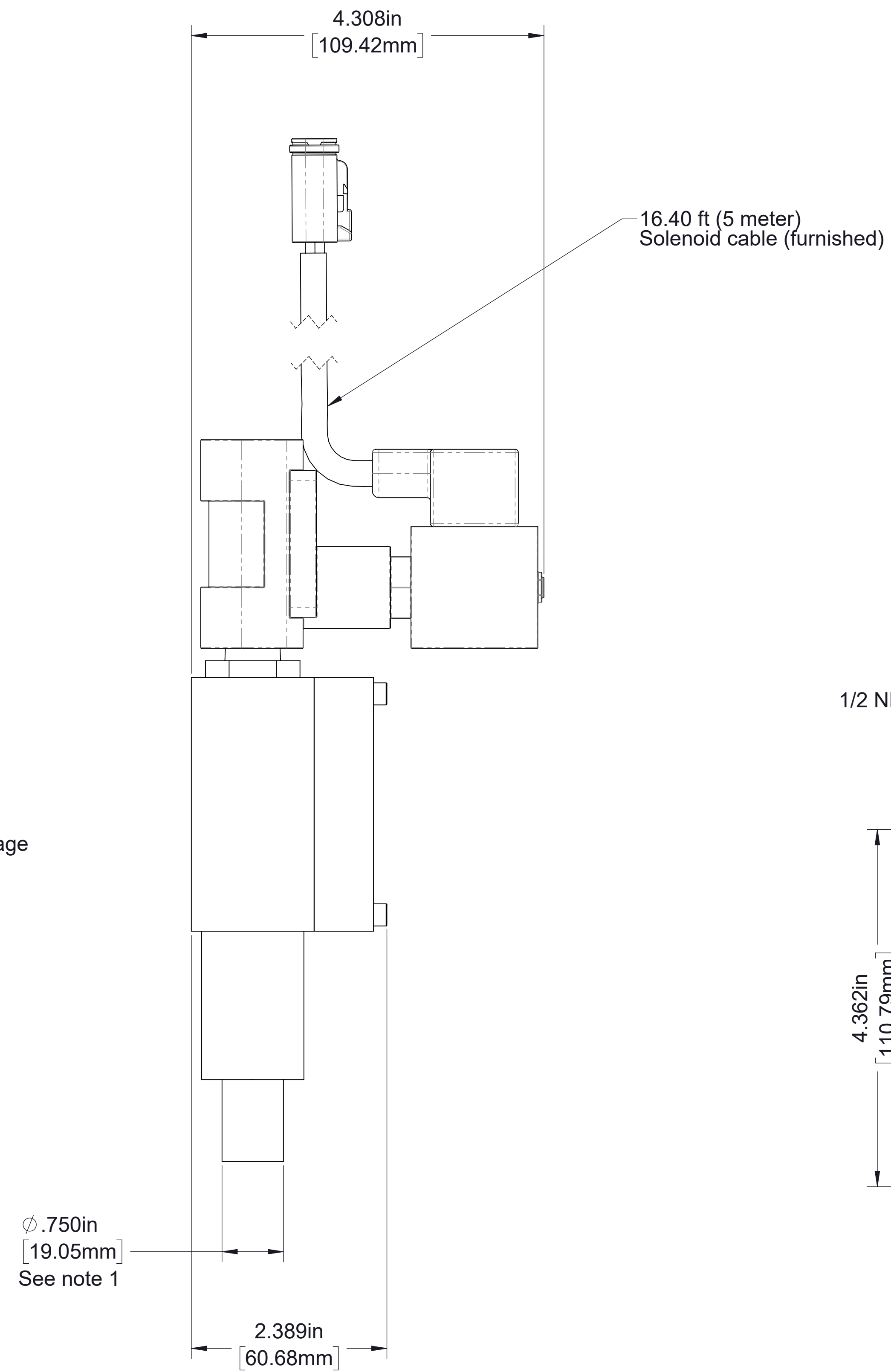

Air Primer Mounted by the OEM

Note:
1. OEM may attach a 3/4 in I.D. hose to air primer to direct exhaust to a more suitable location. Make sure flow is not impeded.

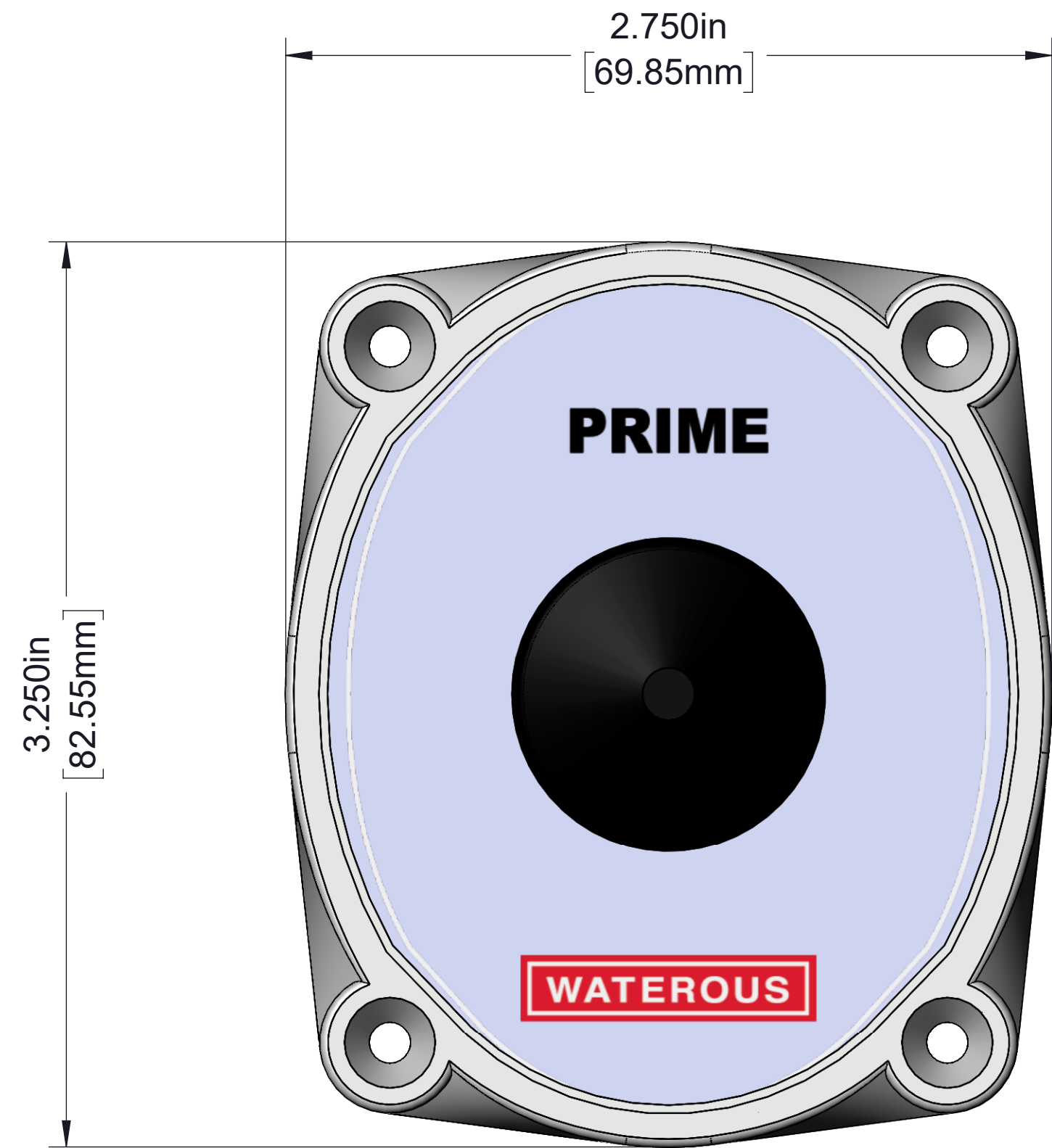

**Push-Button
(Mounting Hardware Included)**

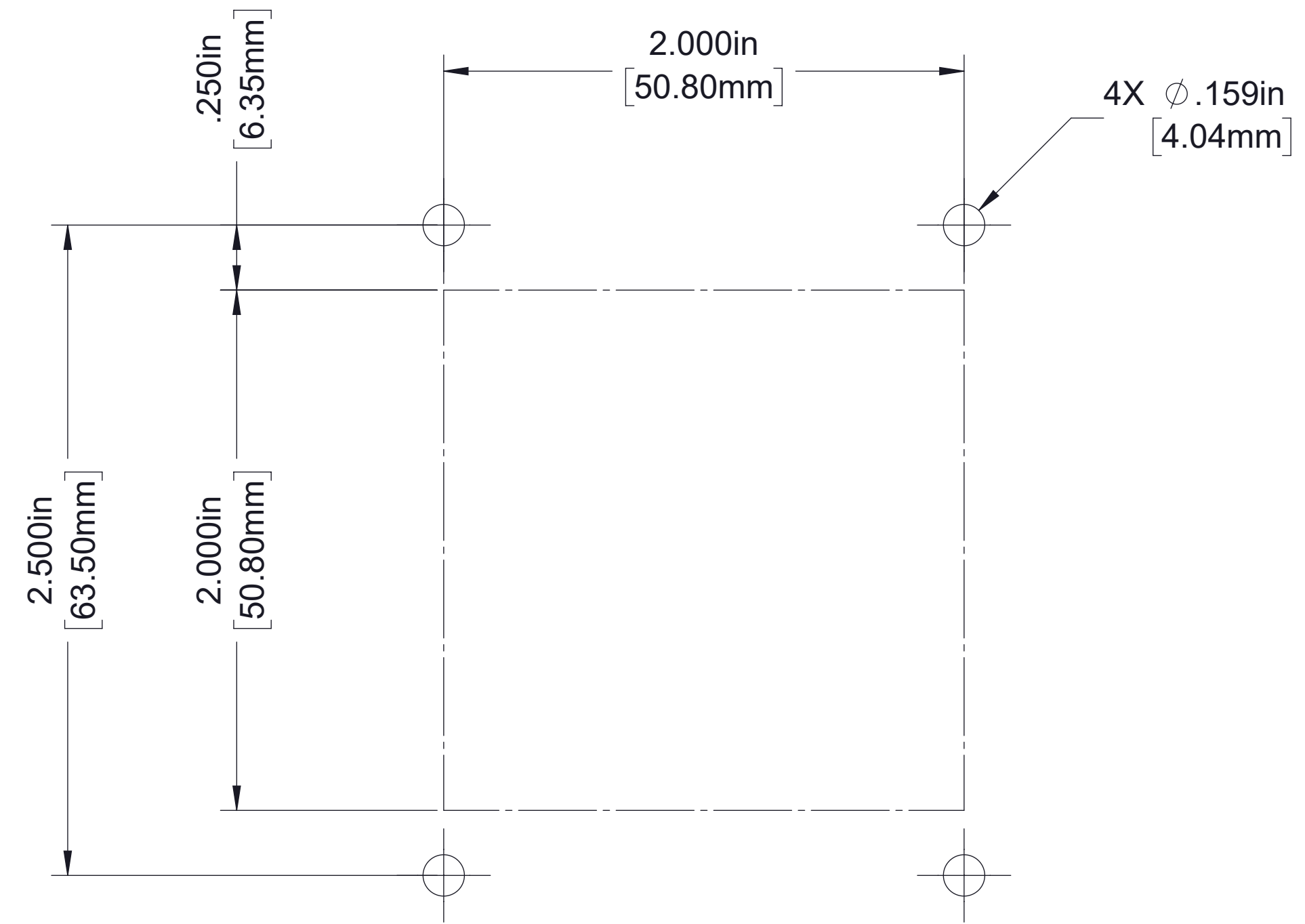

Panel Hole Layout

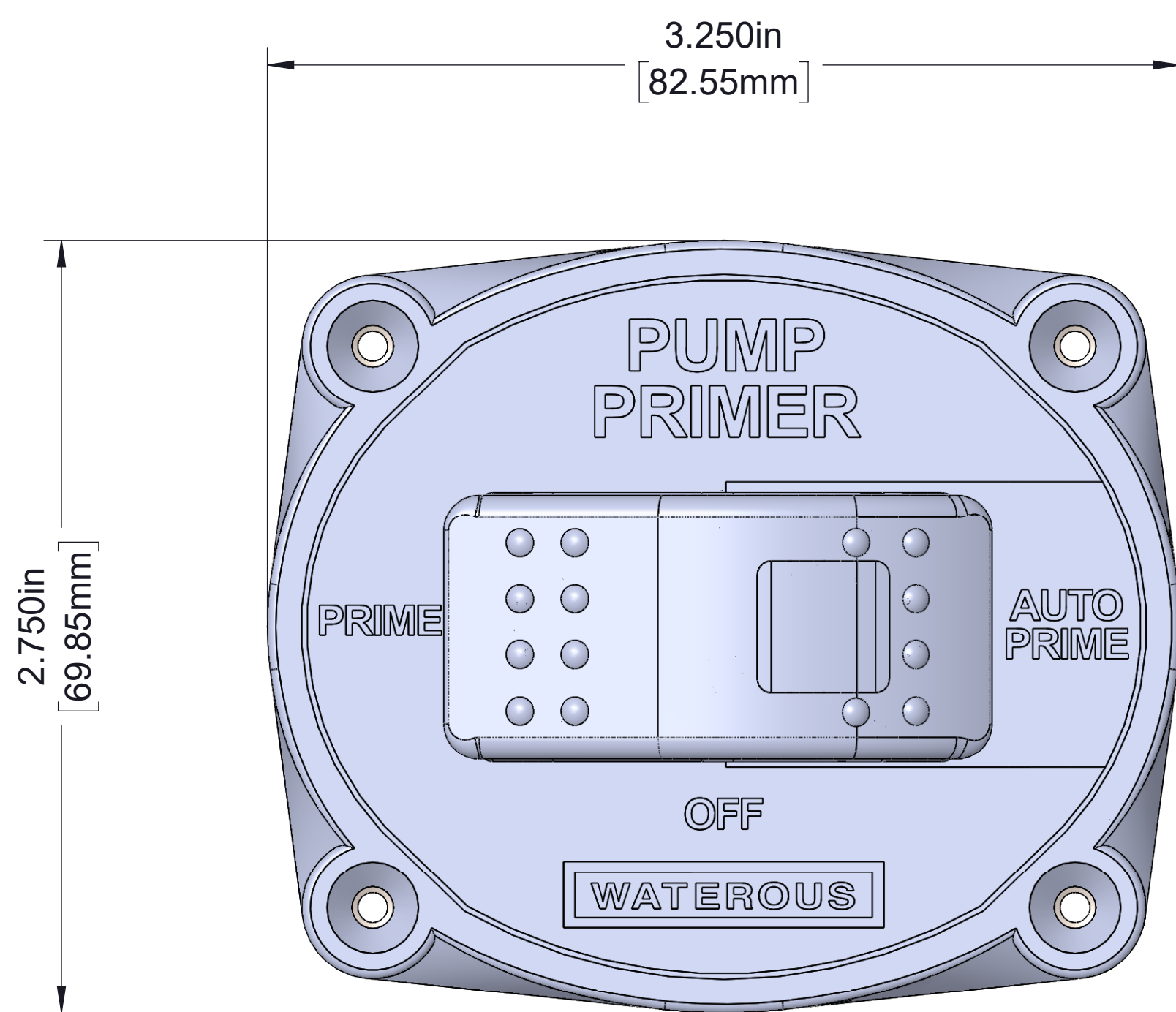

**Rocker Switch
(Mounting Hardware Included)**

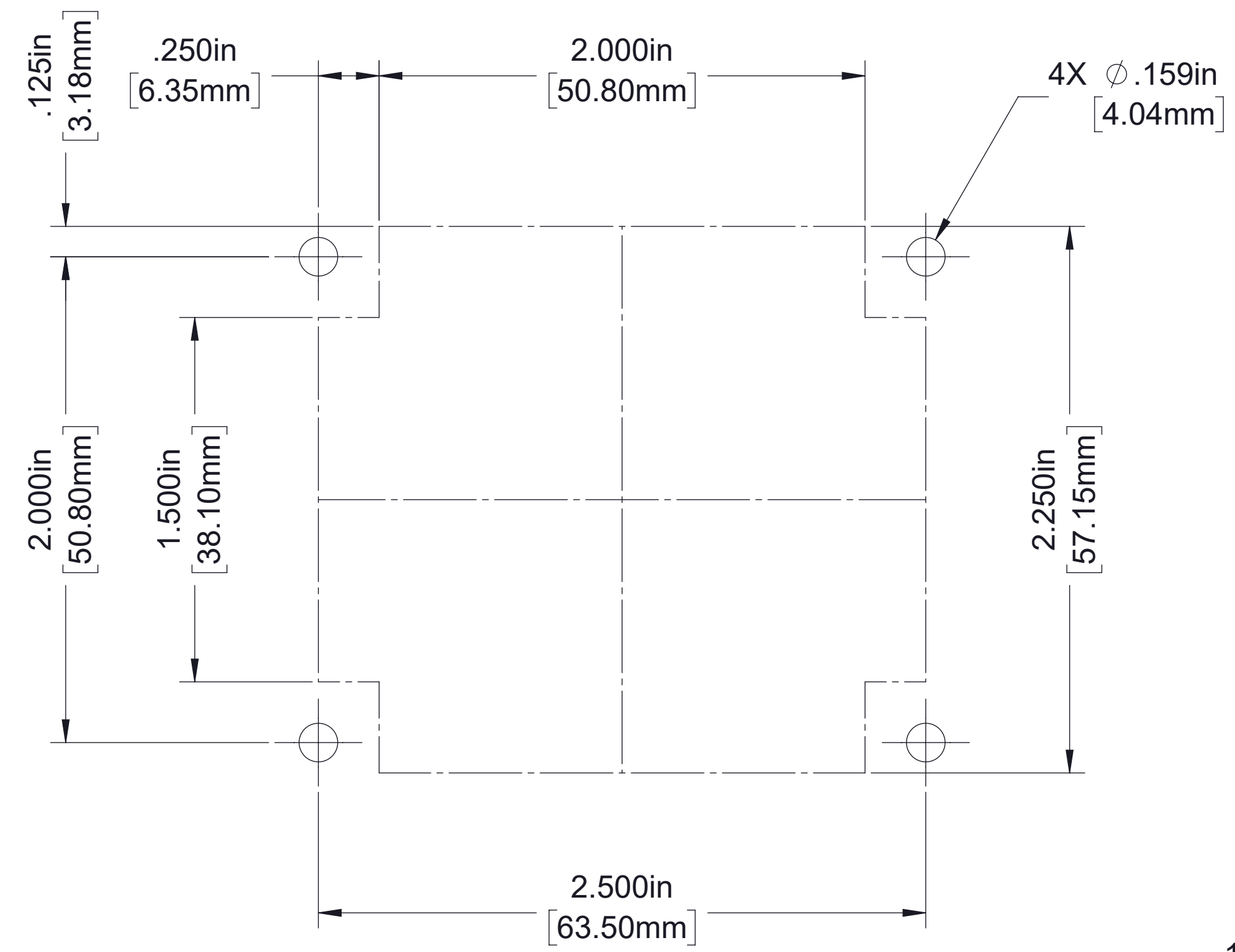

Panel Hole Layout

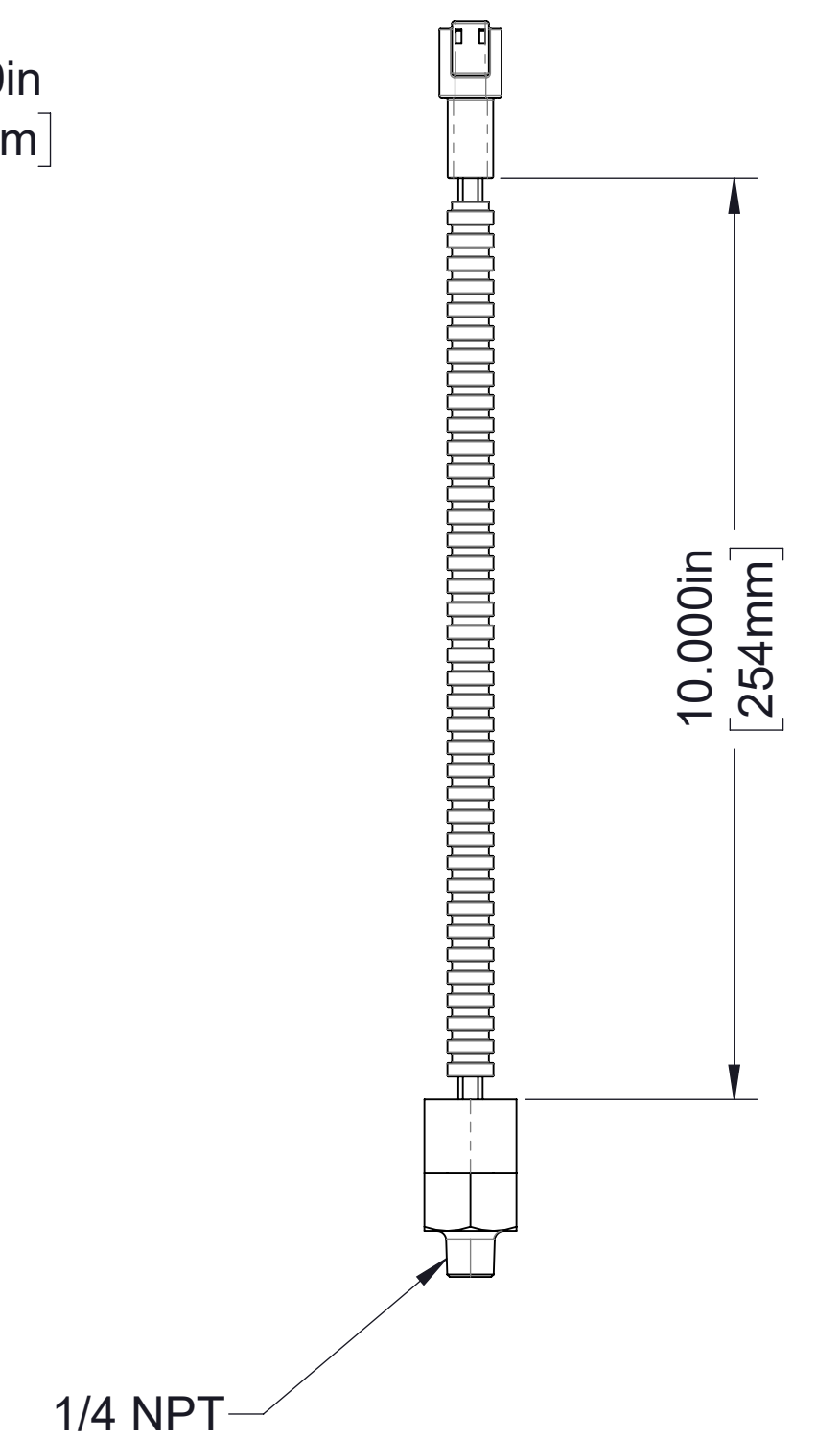

Pressure Switch